

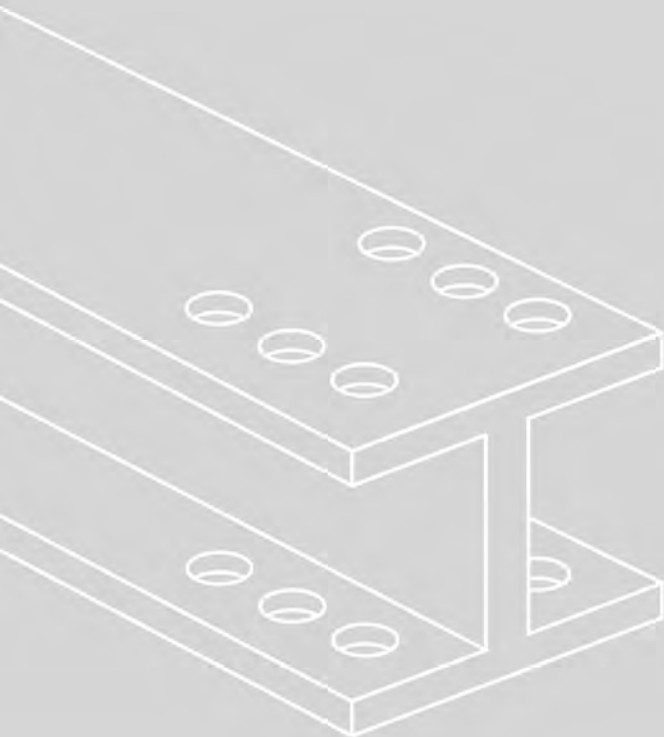

| 恒 | 锋 | 工 | 具 |

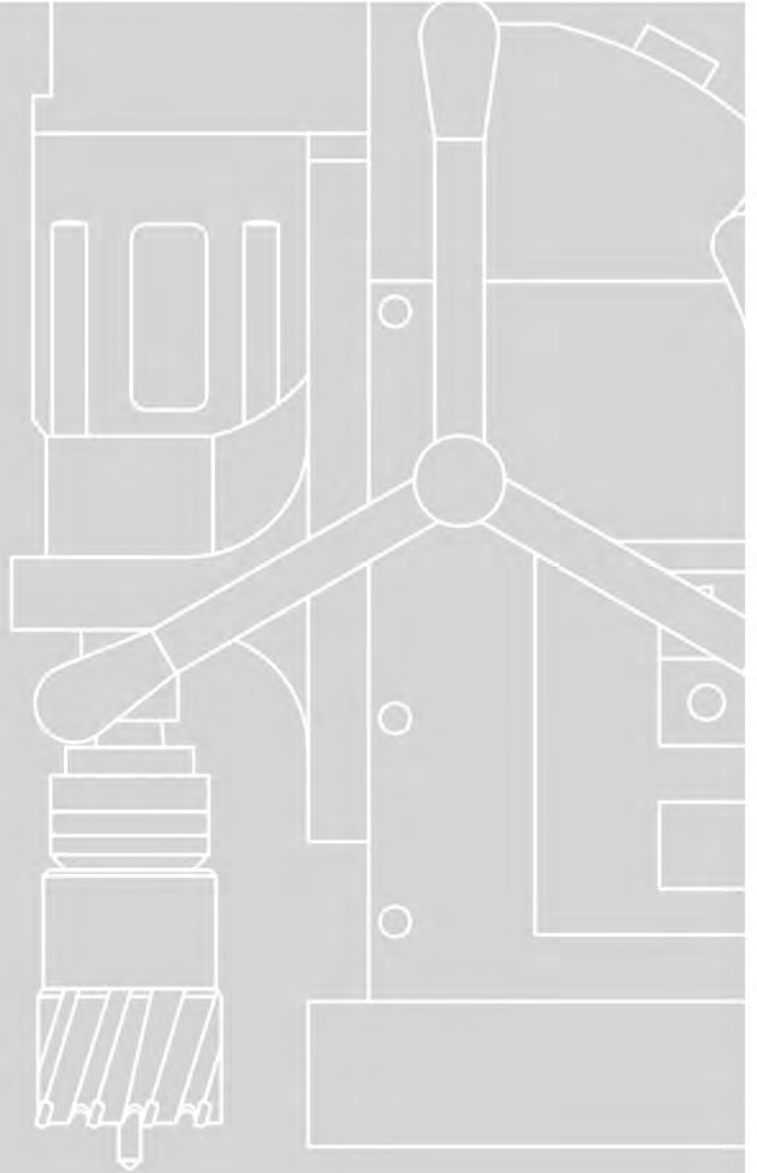

硬质合金钢板钻  
T.C.T. CORE DRILLS







**十五年的制造经验，一流的品质，  
满意的服务，值得信赖的合作伙伴！**

Since founded in 1989, EST TOOLS develops and produces a wide range of T.C.T. Core Drills and Accessories. We provide excellent and dependable quality and satisfactory service. EST is your trusted partner.

镶硬质合金钢板钻 / *T.C.T. Core Drills*

|   |  |
|---|--|
|  <b>CF35</b> ..... 1       |  <b>ICF1"</b> ..... 13     |
|  <b>CF50</b> ..... 2       |  <b>ICF2"</b> ..... 14     |
|  <b>CU35</b> ..... 3       |  <b>ICU1"</b> ..... 15     |
|  <b>CU50</b> ..... 4       |  <b>ICU2"</b> ..... 16     |
|  <b>CW35</b> ..... 5       |  <b>ICW1"</b> ..... 17     |
|  <b>CW50</b> ..... 6       |  <b>ICW2"</b> ..... 18     |
|  <b>CT50</b> ..... 7      |  <b>ICT2"</b> ..... 19    |
|  <b>CWR25/50</b> ..... 8 | " drill" data-bbox="560 485 630 505"/> <b>ICWR1"/"2"</b> ..... 20  |
|  <b>HWR25/50</b> ..... 8 | " drill" data-bbox="565 530 630 550"/> <b>IHWR1"/"2"</b> ..... 20  |
|  <b>CH25</b> ..... 9     |  <b>ICH1"</b> ..... 21   |
|  <b>CH12</b> ..... 10    |  <b>ICH1/2"</b> ..... 22 |
|  <b>CH03</b> ..... 11    |  <b>ICH1/8"</b> ..... 23 |
|  <b>CHP03</b> ..... 12   |  <b>ICH1/8"</b> ..... 24 |

钢板钻附件 / *Core Drill's Accessories*

|  |   |
|--|---|
|  <b>APP</b> ..... 25  |   |
|  <b>ATHW</b> ..... 25 |  <b>ATHT</b> ..... 25 |

|   |  |
|---|--|
| 使用注意事项 / <i>Operation Notice</i> ..... 26 |  |
|---|--|

## 订货编号说明 / Order No. Representation

|                        |                                     |
|------------------------|-------------------------------------|
| C                      | 镶硬质合金钢板钻<br>Tungsten Carbide Tipped |
| H                      | 高速钢板钻<br>High Speed Steel           |
| <b>刀具材料 / Material</b> |                                     |

|                                   |                 |
|-----------------------------------|-----------------|
| R                                 | 加工铁轨 / For rail |
| P                                 | 加工钢管 / For pipe |
| <b>特殊用途 / Special Application</b> |                 |

|                    |                  |
|--------------------|------------------|
| S                  | 短槽 / Short flute |
| L                  | 长槽 / Long flute  |
| <b>槽型 / Groove</b> |                  |



## 非标定制 / Special Size Ordered



CF35



CF35S

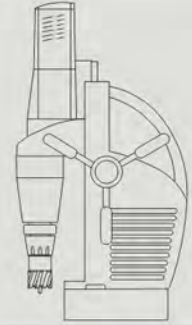

公制标准系列 Metric Regular Size :

<mm>

| 订货编号<br>Order NO. | 外径<br>Dia | 价格<br>Price | 订货编号<br>Order NO. | 外径<br>Dia | 价格<br>Price |
|-------------------|-----------|-------------|-------------------|-----------|-------------|
| CF35S-12          | 12        |             | CF35S-39          | 39        |             |
| CF35S-13          | 13        |             | CF35S-40          | 40        |             |
| CF35S-14          | 14        |             | CF35S-41          | 41        |             |
| CF35S-15          | 15        |             | CF35S-42          | 42        |             |
| CF35S-16          | 16        |             | CF35S-43          | 43        |             |
| CF35S-17          | 17        |             | CF35S-44          | 44        |             |
| CF35S-18          | 18        |             | CF35S-45          | 45        |             |
| CF35S-19          | 19        |             | CF35S-46          | 46        |             |
| CF35S-20          | 20        |             | CF35S-47          | 47        |             |
| CF35S-21          | 21        |             | CF35S-48          | 48        |             |
| CF35S-22          | 22        |             | CF35S-49          | 49        |             |
| CF35S-23          | 23        |             | CF35S-50          | 50        |             |
| CF35S-24          | 24        |             | CF35S-51          | 51        |             |
| CF35S-25          | 25        |             | CF35S-52          | 52        |             |
| CF35S-26          | 26        |             | CF35S-53          | 53        |             |
| CF35S-27          | 27        |             | CF35S-54          | 54        |             |
| CF35S-28          | 28        |             | CF35S-55          | 55        |             |
| CF35S-29          | 29        |             | CF35S-56          | 56        |             |
| CF35S-30          | 30        |             | CF35S-57          | 57        |             |
| CF35S-31          | 31        |             | CF35S-58          | 58        |             |
| CF35S-32          | 32        |             | CF35S-59          | 59        |             |
| CF35S-33          | 33        |             | CF35S-60          | 60        |             |
| CF35S-34          | 34        |             | CF35S-61          | 61        |             |
| CF35S-35          | 35        |             | CF35S-62          | 62        |             |
| CF35S-36          | 36        |             | CF35S-63          | 63        |             |
| CF35S-37          | 37        |             | CF35S-64          | 64        |             |
| CF35S-38          | 38        |             | CF35S-65          | 65        |             |

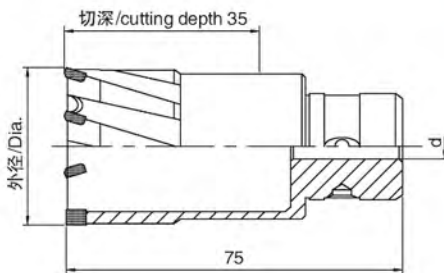

φ 6.35x90 适用于直径12mm—65mm的钢板钻  
Suitable for diameter from 12mm to 65mm

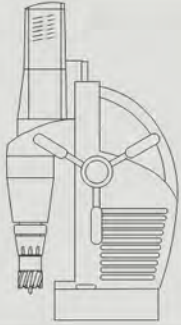

公制标准系列 Metric Regular Size :

<mm>

| 订货编号<br>Order NO. | 外径<br>Dia | 价格<br>Price | 订货编号<br>Order NO. | 外径<br>Dia | 价格<br>Price |
|-------------------|-----------|-------------|-------------------|-----------|-------------|
| CF50S-12          | 12        |             | CF50S-39          | 39        |             |
| CF50S-13          | 13        |             | CF50S-40          | 40        |             |
| CF50S-14          | 14        |             | CF50S-41          | 41        |             |
| CF50S-15          | 15        |             | CF50S-42          | 42        |             |
| CF50S-16          | 16        |             | CF50S-43          | 43        |             |
| CF50S-17          | 17        |             | CF50S-44          | 44        |             |
| CF50S-18          | 18        |             | CF50S-45          | 45        |             |
| CF50S-19          | 19        |             | CF50S-46          | 46        |             |
| CF50S-20          | 20        |             | CF50S-47          | 47        |             |
| CF50S-21          | 21        |             | CF50S-48          | 48        |             |
| CF50S-22          | 22        |             | CF50S-49          | 49        |             |
| CF50S-23          | 23        |             | CF50S-50          | 50        |             |
| CF50S-24          | 24        |             | CF50S-51          | 51        |             |
| CF50S-25          | 25        |             | CF50S-52          | 52        |             |
| CF50S-26          | 26        |             | CF50S-53          | 53        |             |
| CF50S-27          | 27        |             | CF50S-54          | 54        |             |
| CF50S-28          | 28        |             | CF50S-55          | 55        |             |
| CF50S-29          | 29        |             | CF50S-56          | 56        |             |
| CF50S-30          | 30        |             | CF50S-57          | 57        |             |
| CF50S-31          | 31        |             | CF50S-58          | 58        |             |
| CF50S-32          | 32        |             | CF50S-59          | 59        |             |
| CF50S-33          | 33        |             | CF50S-60          | 60        |             |
| CF50S-34          | 34        |             | CF50S-61          | 61        |             |
| CF50S-35          | 35        |             | CF50S-62          | 62        |             |
| CF50S-36          | 36        |             | CF50S-63          | 63        |             |
| CF50S-37          | 37        |             | CF50S-64          | 64        |             |
| CF50S-38          | 38        |             | CF50S-65          | 65        |             |

# CF50



CF50S

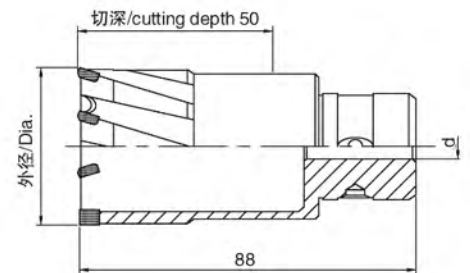

φ 6.35x105 适用于直径12mm—65mm的钢板钻  
Suitable for diameter from 12mm to 65mm

# CU35



CU35S



CU35L

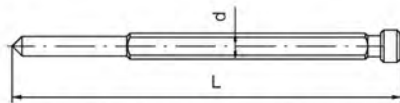
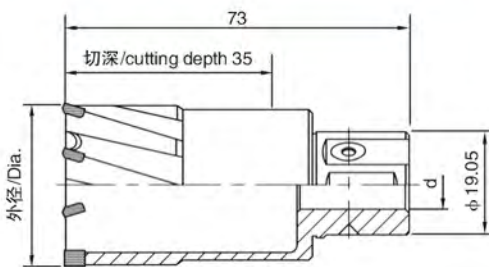

φ6.35x90 适用于直径12mm—17mm的钢板钻  
Suitable for diameter from 12mm to 17mm

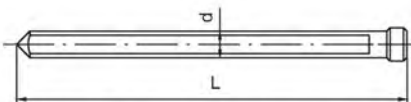

φ8x90 适用于直径18mm—65mm的钢板钻  
Suitable for diameter from 18mm to 65mm

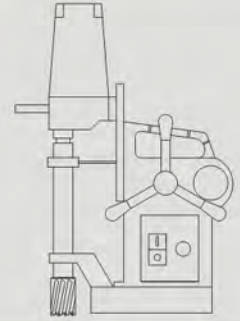

### 公制标准系列 Metric Regular Size :

<mm>

| 订货编号<br>Order NO. | 外径<br>Dia | 价格<br>Price | 订货编号<br>Order NO. | 外径<br>Dia | 价格<br>Price |
|-------------------|-----------|-------------|-------------------|-----------|-------------|
| CU35S/L-12        | 12        |             | CU35S/L-39        | 39        |             |
| CU35S/L-13        | 13        |             | CU35S/L-40        | 40        |             |
| CU35S/L-14        | 14        |             | CU35S/L-41        | 41        |             |
| CU35S/L-15        | 15        |             | CU35S/L-42        | 42        |             |
| CU35S/L-16        | 16        |             | CU35S/L-43        | 43        |             |
| CU35S/L-17        | 17        |             | CU35S/L-44        | 44        |             |
| CU35S/L-18        | 18        |             | CU35S/L-45        | 45        |             |
| CU35S/L-19        | 19        |             | CU35S/L-46        | 46        |             |
| CU35S/L-20        | 20        |             | CU35S/L-47        | 47        |             |
| CU35S/L-21        | 21        |             | CU35S/L-48        | 48        |             |
| CU35S/L-22        | 22        |             | CU35S/L-49        | 49        |             |
| CU35S/L-23        | 23        |             | CU35S/L-50        | 50        |             |
| CU35S/L-24        | 24        |             | CU35S/L-51        | 51        |             |
| CU35S/L-25        | 25        |             | CU35S/L-52        | 52        |             |
| CU35S/L-26        | 26        |             | CU35S/L-53        | 53        |             |
| CU35S/L-27        | 27        |             | CU35S/L-54        | 54        |             |
| CU35S/L-28        | 28        |             | CU35S/L-55        | 55        |             |
| CU35S/L-29        | 29        |             | CU35S/L-56        | 56        |             |
| CU35S/L-30        | 30        |             | CU35S/L-57        | 57        |             |
| CU35S/L-31        | 31        |             | CU35S/L-58        | 58        |             |
| CU35S/L-32        | 32        |             | CU35S/L-59        | 59        |             |
| CU35S/L-33        | 33        |             | CU35S/L-60        | 60        |             |
| CU35S/L-34        | 34        |             | CU35S/L-61        | 61        |             |
| CU35S/L-35        | 35        |             | CU35S/L-62        | 62        |             |
| CU35S/L-36        | 36        |             | CU35S/L-63        | 63        |             |
| CU35S/L-37        | 37        |             | CU35S/L-64        | 64        |             |
| CU35S/L-38        | 38        |             | CU35S/L-65        | 65        |             |



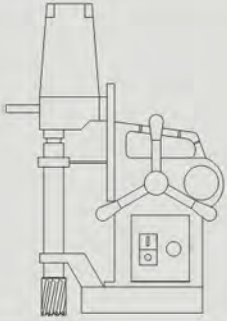

公制标准系列 Metric Regular Size :

<mm>

| 订货编号<br>Order NO. | 外径<br>Dia | 价格<br>Price | 订货编号<br>Order NO. | 外径<br>Dia | 价格<br>Price |
|-------------------|-----------|-------------|-------------------|-----------|-------------|
| CU50S/L-12        | 12        |             | CU50S/L-39        | 39        |             |
| CU50S/L-13        | 13        |             | CU50S/L-40        | 40        |             |
| CU50S/L-14        | 14        |             | CU50S/L-41        | 41        |             |
| CU50S/L-15        | 15        |             | CU50S/L-42        | 42        |             |
| CU50S/L-16        | 16        |             | CU50S/L-43        | 43        |             |
| CU50S/L-17        | 17        |             | CU50S/L-44        | 44        |             |
| CU50S/L-18        | 18        |             | CU50S/L-45        | 45        |             |
| CU50S/L-19        | 19        |             | CU50S/L-46        | 46        |             |
| CU50S/L-20        | 20        |             | CU50S/L-47        | 47        |             |
| CU50S/L-21        | 21        |             | CU50S/L-48        | 48        |             |
| CU50S/L-22        | 22        |             | CU50S/L-49        | 49        |             |
| CU50S/L-23        | 23        |             | CU50S/L-50        | 50        |             |
| CU50S/L-24        | 24        |             | CU50S/L-51        | 51        |             |
| CU50S/L-25        | 25        |             | CU50S/L-52        | 52        |             |
| CU50S/L-26        | 26        |             | CU50S/L-53        | 53        |             |
| CU50S/L-27        | 27        |             | CU50S/L-54        | 54        |             |
| CU50S/L-28        | 28        |             | CU50S/L-55        | 55        |             |
| CU50S/L-29        | 29        |             | CU50S/L-56        | 56        |             |
| CU50S/L-30        | 30        |             | CU50S/L-57        | 57        |             |
| CU50S/L-31        | 31        |             | CU50S/L-58        | 58        |             |
| CU50S/L-32        | 32        |             | CU50S/L-59        | 59        |             |
| CU50S/L-33        | 33        |             | CU50S/L-60        | 60        |             |
| CU50S/L-34        | 34        |             | CU50S/L-61        | 61        |             |
| CU50S/L-35        | 35        |             | CU50S/L-62        | 62        |             |
| CU50S/L-36        | 36        |             | CU50S/L-63        | 63        |             |
| CU50S/L-37        | 37        |             | CU50S/L-64        | 64        |             |
| CU50S/L-38        | 38        |             | CU50S/L-65        | 65        |             |

# CU50



CU50S



CU50L

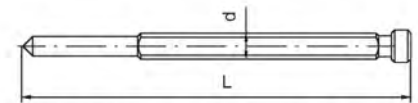
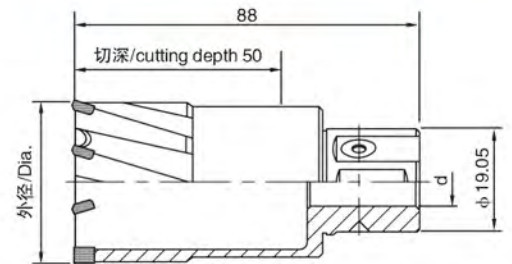

φ 6.35x105 适用于直径12mm—17mm的钢板钻  
Suitable for diameter from 12mm to 17mm

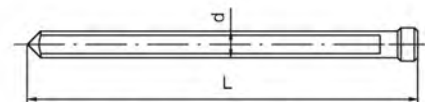

φ 8x105 适用于直径18mm—65mm的钢板钻  
Suitable for diameter from 18mm to 65mm

# CW35



CW35S



CW35L

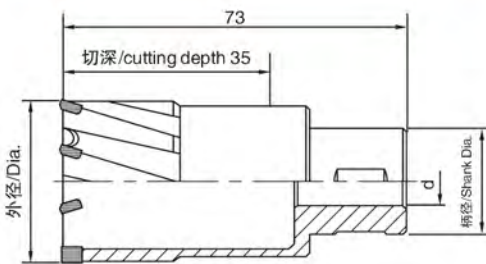

柄径/Shank Dia.:

外径/Dia. 12~65 柄径/Shank Dia. 19.05

外径/Dia. 66~ 柄径/Shank Dia. 31.75

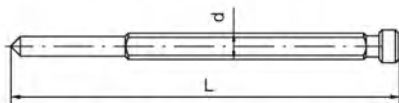

φ 6.35x90 适用于直径12mm—17mm的钢板钻  
Suitable for diameter from 12mm to 17mm

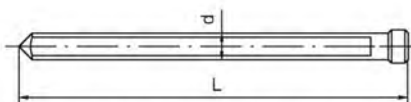

φ 8x90 适用于直径18mm—100mm的钢板钻  
Suitable for diameter from 18mm to 100mm

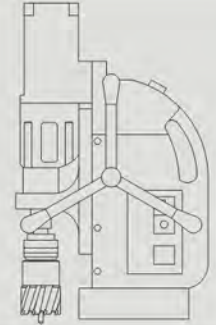

## 公制标准系列 Metric Regular Size :

<mm>

| 订货编号<br>Order NO. | 外径<br>Dia | 价格<br>Price | 订货编号<br>Order NO. | 外径<br>Dia | 价格<br>Price |
|-------------------|-----------|-------------|-------------------|-----------|-------------|
| CW35S/L-12        | 12        |             | CW35S/L-57        | 57        |             |
| CW35S/L-13        | 13        |             | CW35S/L-58        | 58        |             |
| CW35S/L-14        | 14        |             | CW35S/L-59        | 59        |             |
| CW35S/L-15        | 15        |             | CW35S/L-60        | 60        |             |
| CW35S/L-16        | 16        |             | CW35S/L-61        | 61        |             |
| CW35S/L-17        | 17        |             | CW35S/L-62        | 62        |             |
| CW35S/L-18        | 18        |             | CW35S/L-63        | 63        |             |
| CW35S/L-19        | 19        |             | CW35S/L-64        | 64        |             |
| CW35S/L-20        | 20        |             | CW35S/L-65        | 65        |             |
| CW35S/L-21        | 21        |             | CW35S/L-66        | 66        |             |
| CW35S/L-22        | 22        |             | CW35S/L-67        | 67        |             |
| CW35S/L-23        | 23        |             | CW35S/L-68        | 68        |             |
| CW35S/L-24        | 24        |             | CW35S/L-69        | 69        |             |
| CW35S/L-25        | 25        |             | CW35S/L-70        | 70        |             |
| CW35S/L-26        | 26        |             | CW35S/L-71        | 71        |             |
| CW35S/L-27        | 27        |             | CW35S/L-72        | 72        |             |
| CW35S/L-28        | 28        |             | CW35S/L-73        | 73        |             |
| CW35S/L-29        | 29        |             | CW35S/L-74        | 74        |             |
| CW35S/L-30        | 30        |             | CW35S/L-75        | 75        |             |
| CW35S/L-31        | 31        |             | CW35S/L-76        | 76        |             |
| CW35S/L-32        | 32        |             | CW35S/L-77        | 77        |             |
| CW35S/L-33        | 33        |             | CW35S/L-78        | 78        |             |
| CW35S/L-34        | 34        |             | CW35S/L-79        | 79        |             |
| CW35S/L-35        | 35        |             | CW35S/L-80        | 80        |             |
| CW35S/L-36        | 36        |             | CW35S/L-81        | 81        |             |
| CW35S/L-37        | 37        |             | CW35S/L-82        | 82        |             |
| CW35S/L-38        | 38        |             | CW35S/L-83        | 83        |             |
| CW35S/L-39        | 39        |             | CW35S/L-84        | 84        |             |
| CW35S/L-40        | 40        |             | CW35S/L-85        | 85        |             |
| CW35S/L-41        | 41        |             | CW35S/L-86        | 86        |             |
| CW35S/L-42        | 42        |             | CW35S/L-87        | 87        |             |
| CW35S/L-43        | 43        |             | CW35S/L-88        | 88        |             |
| CW35S/L-44        | 44        |             | CW35S/L-89        | 89        |             |
| CW35S/L-45        | 45        |             | CW35S/L-90        | 90        |             |
| CW35S/L-46        | 46        |             | CW35S/L-91        | 91        |             |
| CW35S/L-47        | 47        |             | CW35S/L-92        | 92        |             |
| CW35S/L-48        | 48        |             | CW35S/L-93        | 93        |             |
| CW35S/L-49        | 49        |             | CW35S/L-94        | 94        |             |
| CW35S/L-50        | 50        |             | CW35S/L-95        | 95        |             |
| CW35S/L-51        | 51        |             | CW35S/L-96        | 96        |             |
| CW35S/L-52        | 52        |             | CW35S/L-97        | 97        |             |
| CW35S/L-53        | 53        |             | CW35S/L-98        | 98        |             |
| CW35S/L-54        | 54        |             | CW35S/L-99        | 99        |             |
| CW35S/L-55        | 55        |             | CW35S/L-100       | 100       |             |
| CW35S/L-56        | 56        |             |                   |           |             |

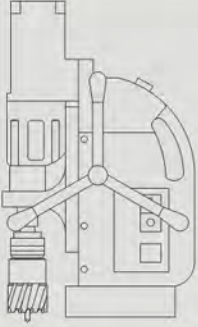

公制标准系列 Metric Regular Size :

<mm>

| 订货编号<br>Order NO. | 外径<br>Dia | 价格<br>Price | 订货编号<br>Order NO. | 外径<br>Dia | 价格<br>Price |
|-------------------|-----------|-------------|-------------------|-----------|-------------|
| CW50S/L-12        | 12        |             | CW50S/L-57        | 57        |             |
| CW50S/L-13        | 13        |             | CW50S/L-58        | 58        |             |
| CW50S/L-14        | 14        |             | CW50S/L-59        | 59        |             |
| CW50S/L-15        | 15        |             | CW50S/L-60        | 60        |             |
| CW50S/L-16        | 16        |             | CW50S/L-61        | 61        |             |
| CW50S/L-17        | 17        |             | CW50S/L-62        | 62        |             |
| CW50S/L-18        | 18        |             | CW50S/L-63        | 63        |             |
| CW50S/L-19        | 19        |             | CW50S/L-64        | 64        |             |
| CW50S/L-20        | 20        |             | CW50S/L-65        | 65        |             |
| CW50S/L-21        | 21        |             | CW50S/L-66        | 66        |             |
| CW50S/L-22        | 22        |             | CW50S/L-67        | 67        |             |
| CW50S/L-23        | 23        |             | CW50S/L-68        | 68        |             |
| CW50S/L-24        | 24        |             | CW50S/L-69        | 69        |             |
| CW50S/L-25        | 25        |             | CW50S/L-70        | 70        |             |
| CW50S/L-26        | 26        |             | CW50S/L-71        | 71        |             |
| CW50S/L-27        | 27        |             | CW50S/L-72        | 72        |             |
| CW50S/L-28        | 28        |             | CW50S/L-73        | 73        |             |
| CW50S/L-29        | 29        |             | CW50S/L-74        | 74        |             |
| CW50S/L-30        | 30        |             | CW50S/L-75        | 75        |             |
| CW50S/L-31        | 31        |             | CW50S/L-76        | 76        |             |
| CW50S/L-32        | 32        |             | CW50S/L-77        | 77        |             |
| CW50S/L-33        | 33        |             | CW50S/L-78        | 78        |             |
| CW50S/L-34        | 34        |             | CW50S/L-79        | 79        |             |
| CW50S/L-35        | 35        |             | CW50S/L-80        | 80        |             |
| CW50S/L-36        | 36        |             | CW50S/L-81        | 81        |             |
| CW50S/L-37        | 37        |             | CW50S/L-82        | 82        |             |
| CW50S/L-38        | 38        |             | CW50S/L-83        | 83        |             |
| CW50S/L-39        | 39        |             | CW50S/L-84        | 84        |             |
| CW50S/L-40        | 40        |             | CW50S/L-85        | 85        |             |
| CW50S/L-41        | 41        |             | CW50S/L-86        | 86        |             |
| CW50S/L-42        | 42        |             | CW50S/L-87        | 87        |             |
| CW50S/L-43        | 43        |             | CW50S/L-88        | 88        |             |
| CW50S/L-44        | 44        |             | CW50S/L-89        | 89        |             |
| CW50S/L-45        | 45        |             | CW50S/L-90        | 90        |             |
| CW50S/L-46        | 46        |             | CW50S/L-91        | 91        |             |
| CW50S/L-47        | 47        |             | CW50S/L-92        | 92        |             |
| CW50S/L-48        | 48        |             | CW50S/L-93        | 93        |             |
| CW50S/L-49        | 49        |             | CW50S/L-94        | 94        |             |
| CW50S/L-50        | 50        |             | CW50S/L-95        | 95        |             |
| CW50S/L-51        | 51        |             | CW50S/L-96        | 96        |             |
| CW50S/L-52        | 52        |             | CW50S/L-97        | 97        |             |
| CW50S/L-53        | 53        |             | CW50S/L-98        | 98        |             |
| CW50S/L-54        | 54        |             | CW50S/L-99        | 99        |             |
| CW50S/L-55        | 55        |             | CW50S/L-100       | 100       |             |
| CW50S/L-56        | 56        |             |                   |           |             |

# CW50



CW50S



CW50L

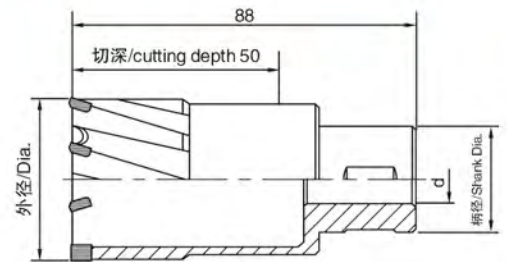

柄径/Shank Dia. :

外径/Dia. 12-65 柄径/Shank Dia. 19.05

外径/Dia. 66~ 柄径/Shank Dia. 31.75

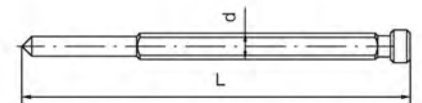

φ 6.35x105 适用于直径12mm—17mm的钢板钻  
Suitable for diameter from 12mm to 17mm

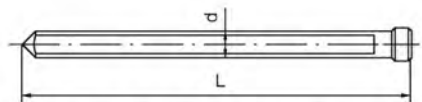

φ 8x105 适用于直径18mm—100mm的钢板钻  
Suitable for diameter from 18mm to 100mm

CT50



CT50S



CT50S

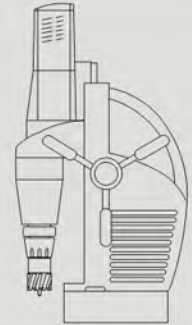

公制标准系列 Metric Regular Size :

<mm>

| 订货编号<br>Order NO. | 外径<br>Dia | 价格<br>Price | 订货编号<br>Order NO. | 外径<br>Dia | 价格<br>Price |
|-------------------|-----------|-------------|-------------------|-----------|-------------|
| CT50S-12          | 12        |             | CT50S-57          | 57        |             |
| CT50S-13          | 13        |             | CT50S-58          | 58        |             |
| CT50S-14          | 14        |             | CT50S-59          | 59        |             |
| CT50S-15          | 15        |             | CT50S-60          | 60        |             |
| CT50S-16          | 16        |             | CT50S-61          | 61        |             |
| CT50S-17          | 17        |             | CT50S-62          | 62        |             |
| CT50S-18          | 18        |             | CT50S-63          | 63        |             |
| CT50S-19          | 19        |             | CT50S-64          | 64        |             |
| CT50S-20          | 20        |             | CT50S-65          | 65        |             |
| CT50S-21          | 21        |             | CT50S-66          | 66        |             |
| CT50S-22          | 22        |             | CT50S-67          | 67        |             |
| CT50S-23          | 23        |             | CT50S-68          | 68        |             |
| CT50S-24          | 24        |             | CT50S-69          | 69        |             |
| CT50S-25          | 25        |             | CT50S-70          | 70        |             |
| CT50S-26          | 26        |             | CT50S-71          | 71        |             |
| CT50S-27          | 27        |             | CT50S-72          | 72        |             |
| CT50S-28          | 28        |             | CT50S-73          | 73        |             |
| CT50S-29          | 29        |             | CT50S-74          | 74        |             |
| CT50S-30          | 30        |             | CT50S-75          | 75        |             |
| CT50S-31          | 31        |             | CT50S-76          | 76        |             |
| CT50S-32          | 32        |             | CT50S-77          | 77        |             |
| CT50S-33          | 33        |             | CT50S-78          | 78        |             |
| CT50S-34          | 34        |             | CT50S-79          | 79        |             |
| CT50S-35          | 35        |             | CT50S-80          | 80        |             |
| CT50S-36          | 36        |             | CT50S-81          | 81        |             |
| CT50S-37          | 37        |             | CT50S-82          | 82        |             |
| CT50S-38          | 38        |             | CT50S-83          | 83        |             |
| CT50S-39          | 39        |             | CT50S-84          | 84        |             |
| CT50S-40          | 40        |             | CT50S-85          | 85        |             |
| CT50S-41          | 41        |             | CT50S-86          | 86        |             |
| CT50S-42          | 42        |             | CT50S-87          | 87        |             |
| CT50S-43          | 43        |             | CT50S-88          | 88        |             |
| CT50S-44          | 44        |             | CT50S-89          | 89        |             |
| CT50S-45          | 45        |             | CT50S-90          | 90        |             |
| CT50S-46          | 46        |             | CT50S-91          | 91        |             |
| CT50S-47          | 47        |             | CT50S-92          | 92        |             |
| CT50S-48          | 48        |             | CT50S-93          | 93        |             |
| CT50S-49          | 49        |             | CT50S-94          | 94        |             |
| CT50S-50          | 50        |             | CT50S-95          | 95        |             |
| CT50S-51          | 51        |             | CT50S-96          | 96        |             |
| CT50S-52          | 52        |             | CT50S-97          | 97        |             |
| CT50S-53          | 53        |             | CT50S-98          | 98        |             |
| CT50S-54          | 54        |             | CT50S-99          | 99        |             |
| CT50S-55          | 55        |             | CT50S-100         | 100       |             |
| CT50S-56          | 56        |             |                   |           |             |

削平柄钢轨钻/切深25mm或50mm

Rail Cutting Core Drills with Weldon Shank/Cutting depth 25mm or 50mm



| 硬 | 锋 | 工 | 具 |

CWR25  
CWR50



CWR25S  
CWR50S

HWR25  
HWR50



HWR25L  
HWR50L

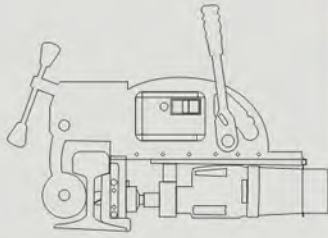

公制标准系列 Metric Regular Size :

<mm>

| 订货编号<br>Order NO. | 外径<br>Dia | 价格<br>Price | 订货编号<br>Order NO. | 外径<br>Dia | 价格<br>Price |
|-------------------|-----------|-------------|-------------------|-----------|-------------|
| CWR25S-20         | 20        |             | CWR50S-20         | 20        |             |
| CWR25S-21         | 21        |             | CWR50S-21         | 21        |             |
| CWR25S-22         | 22        |             | CWR50S-22         | 22        |             |
| CWR25S-23         | 23        |             | CWR50S-23         | 23        |             |
| CWR25S-24         | 24        |             | CWR50S-24         | 24        |             |
| CWR25S-25         | 25        |             | CWR50S-25         | 25        |             |
| CWR25S-26         | 26        |             | CWR50S-26         | 26        |             |
| CWR25S-27         | 27        |             | CWR50S-27         | 27        |             |
| CWR25S-28         | 28        |             | CWR50S-28         | 28        |             |
| CWR25S-29         | 29        |             | CWR50S-29         | 29        |             |
| CWR25S-30         | 30        |             | CWR50S-30         | 30        |             |
| CWR25S-31         | 31        |             | CWR50S-31         | 31        |             |
| CWR25S-32         | 32        |             | CWR50S-32         | 32        |             |
| CWR25S-33         | 33        |             | CWR50S-33         | 33        |             |
| CWR25S-34         | 34        |             | CWR50S-34         | 34        |             |
| CWR25S-35         | 35        |             | CWR50S-35         | 35        |             |
| CWR25S-36         | 36        |             | CWR50S-36         | 36        |             |

公制标准系列 Metric Regular Size :

<mm>

| 订货编号<br>Order NO. | 外径<br>Dia | 价格<br>Price | 订货编号<br>Order NO. | 外径<br>Dia | 价格<br>Price |
|-------------------|-----------|-------------|-------------------|-----------|-------------|
| HWR25L-20         | 20        |             | HWR50L-20         | 20        |             |
| HWR25L-21         | 21        |             | HWR50L-21         | 21        |             |
| HWR25L-22         | 22        |             | HWR50L-22         | 22        |             |
| HWR25L-23         | 23        |             | HWR50L-23         | 23        |             |
| HWR25L-24         | 24        |             | HWR50L-24         | 24        |             |
| HWR25L-25         | 25        |             | HWR50L-25         | 25        |             |
| HWR25L-26         | 26        |             | HWR50L-26         | 26        |             |
| HWR25L-27         | 27        |             | HWR50L-27         | 27        |             |
| HWR25L-28         | 28        |             | HWR50L-28         | 28        |             |
| HWR25L-29         | 29        |             | HWR50L-29         | 29        |             |
| HWR25L-30         | 30        |             | HWR50L-30         | 30        |             |
| HWR25L-31         | 31        |             | HWR50L-31         | 31        |             |
| HWR25L-32         | 32        |             | HWR50L-32         | 32        |             |
| HWR25L-33         | 33        |             | HWR50L-33         | 33        |             |
| HWR25L-34         | 34        |             | HWR50L-34         | 34        |             |
| HWR25L-35         | 35        |             | HWR50L-35         | 35        |             |
| HWR25L-36         | 36        |             | HWR50L-36         | 36        |             |

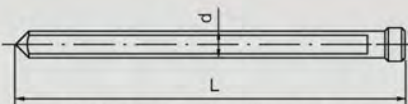

φ 8x90 适用于直径20—36mm的钢轨钻  
Suitable for diameter from 20mm to 36mm

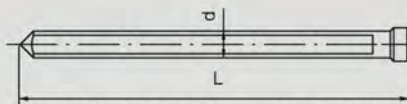

φ 8x105 适用于直径20mm—36mm的钢板钻  
Suitable for diameter from 20mm to 36mm

# CH25

外径/Dia.15~30



外径/Dia.31~



公制标准系列 Metric Regular Size :

<mm>

| 订货编号<br>Order NO. | 外径<br>Dia | 价格<br>Price | 订货编号<br>Order NO. | 外径<br>Dia | 价格<br>Price | 订货编号<br>Order NO. | 外径<br>Dia | 价格<br>Price |
|-------------------|-----------|-------------|-------------------|-----------|-------------|-------------------|-----------|-------------|
| CH25-15           | 15        |             | CH25-61           | 61        |             | CH25-107          | 107       |             |
| CH25-16           | 16        |             | CH25-62           | 62        |             | CH25-108          | 108       |             |
| CH25-17           | 17        |             | CH25-63           | 63        |             | CH25-109          | 109       |             |
| CH25-18           | 18        |             | CH25-64           | 64        |             | CH25-110          | 110       |             |
| CH25-19           | 19        |             | CH25-65           | 65        |             | CH25-111          | 111       |             |
| CH25-20           | 20        |             | CH25-66           | 66        |             | CH25-112          | 112       |             |
| CH25-21           | 21        |             | CH25-67           | 67        |             | CH25-113          | 113       |             |
| CH25-22           | 22        |             | CH25-68           | 68        |             | CH25-114          | 114       |             |
| CH25-23           | 23        |             | CH25-69           | 69        |             | CH25-115          | 115       |             |
| CH25-24           | 24        |             | CH25-70           | 70        |             | CH25-116          | 116       |             |
| CH25-25           | 25        |             | CH25-71           | 71        |             | CH25-117          | 117       |             |
| CH25-26           | 26        |             | CH25-72           | 72        |             | CH25-118          | 118       |             |
| CH25-27           | 27        |             | CH25-73           | 73        |             | CH25-119          | 119       |             |
| CH25-28           | 28        |             | CH25-74           | 74        |             | CH25-120          | 120       |             |
| CH25-29           | 29        |             | CH25-75           | 75        |             | CH25-121          | 121       |             |
| CH25-30           | 30        |             | CH25-76           | 76        |             | CH25-122          | 122       |             |
| CH25-31           | 31        |             | CH25-77           | 77        |             | CH25-123          | 123       |             |
| CH25-32           | 32        |             | CH25-78           | 78        |             | CH25-124          | 124       |             |
| CH25-33           | 33        |             | CH25-79           | 79        |             | CH25-125          | 125       |             |
| CH25-34           | 34        |             | CH25-80           | 80        |             | CH25-126          | 126       |             |
| CH25-35           | 35        |             | CH25-81           | 81        |             | CH25-127          | 127       |             |
| CH25-36           | 36        |             | CH25-82           | 82        |             | CH25-128          | 128       |             |
| CH25-37           | 37        |             | CH25-83           | 83        |             | CH25-129          | 129       |             |
| CH25-38           | 38        |             | CH25-84           | 84        |             | CH25-130          | 130       |             |
| CH25-39           | 39        |             | CH25-85           | 85        |             | CH25-131          | 131       |             |
| CH25-40           | 40        |             | CH25-86           | 86        |             | CH25-132          | 132       |             |
| CH25-41           | 41        |             | CH25-87           | 87        |             | CH25-133          | 133       |             |
| CH25-42           | 42        |             | CH25-88           | 88        |             | CH25-134          | 134       |             |
| CH25-43           | 43        |             | CH25-89           | 89        |             | CH25-135          | 135       |             |
| CH25-44           | 44        |             | CH25-90           | 90        |             | CH25-136          | 136       |             |
| CH25-45           | 45        |             | CH25-91           | 91        |             | CH25-137          | 137       |             |
| CH25-46           | 46        |             | CH25-92           | 92        |             | CH25-138          | 138       |             |
| CH25-47           | 47        |             | CH25-93           | 93        |             | CH25-139          | 139       |             |
| CH25-48           | 48        |             | CH25-94           | 94        |             | CH25-140          | 140       |             |
| CH25-49           | 49        |             | CH25-95           | 95        |             | CH25-141          | 141       |             |
| CH25-50           | 50        |             | CH25-96           | 96        |             | CH25-142          | 142       |             |
| CH25-51           | 51        |             | CH25-97           | 97        |             | CH25-143          | 143       |             |
| CH25-52           | 52        |             | CH25-98           | 98        |             | CH25-144          | 144       |             |
| CH25-53           | 53        |             | CH25-99           | 99        |             | CH25-145          | 145       |             |
| CH25-54           | 54        |             | CH25-100          | 100       |             | CH25-146          | 146       |             |
| CH25-55           | 55        |             | CH25-101          | 101       |             | CH25-147          | 147       |             |
| CH25-56           | 56        |             | CH25-102          | 102       |             | CH25-148          | 148       |             |
| CH25-57           | 57        |             | CH25-103          | 103       |             | CH25-149          | 149       |             |
| CH25-58           | 58        |             | CH25-104          | 104       |             | CH25-150          | 150       |             |
| CH25-59           | 59        |             | CH25-105          | 105       |             |                   |           |             |
| CH25-60           | 60        |             | CH25-106          | 106       |             |                   |           |             |



# CH12

外径/Dia.15~30



公制标准系列 Metric Regular Size :

<mm>

| 订货编号<br>Order NO. | 外径<br>Dia | 价格<br>Price | 订货编号<br>Order NO. | 外径<br>Dia | 价格<br>Price | 订货编号<br>Order NO. | 外径<br>Dia | 价格<br>Price |
|-------------------|-----------|-------------|-------------------|-----------|-------------|-------------------|-----------|-------------|
| CH12-15           | 15        |             | CH12-51           | 51        |             | CH12-87           | 87        |             |
| CH12-16           | 16        |             | CH12-52           | 52        |             | CH12-88           | 88        |             |
| CH12-17           | 17        |             | CH12-53           | 53        |             | CH12-89           | 89        |             |
| CH12-18           | 18        |             | CH12-54           | 54        |             | CH12-90           | 90        |             |
| CH12-19           | 19        |             | CH12-55           | 55        |             | CH12-91           | 91        |             |
| CH12-20           | 20        |             | CH12-56           | 56        |             | CH12-92           | 92        |             |
| CH12-21           | 21        |             | CH12-57           | 57        |             | CH12-93           | 93        |             |
| CH12-22           | 22        |             | CH12-58           | 58        |             | CH12-94           | 94        |             |
| CH12-23           | 23        |             | CH12-59           | 59        |             | CH12-95           | 95        |             |
| CH12-24           | 24        |             | CH12-60           | 60        |             | CH12-96           | 96        |             |
| CH12-25           | 25        |             | CH12-61           | 61        |             | CH12-97           | 97        |             |
| CH12-26           | 26        |             | CH12-62           | 62        |             | CH12-98           | 98        |             |
| CH12-27           | 27        |             | CH12-63           | 63        |             | CH12-99           | 99        |             |
| CH12-28           | 28        |             | CH12-64           | 64        |             | CH12-100          | 100       |             |
| CH12-29           | 29        |             | CH12-65           | 65        |             | CH12-101          | 101       |             |
| CH12-30           | 30        |             | CH12-66           | 66        |             | CH12-102          | 102       |             |
| CH12-31           | 31        |             | CH12-67           | 67        |             | CH12-103          | 103       |             |
| CH12-32           | 32        |             | CH12-68           | 68        |             | CH12-104          | 104       |             |
| CH12-33           | 33        |             | CH12-69           | 69        |             | CH12-105          | 105       |             |
| CH12-34           | 34        |             | CH12-70           | 70        |             | CH12-106          | 106       |             |
| CH12-35           | 35        |             | CH12-71           | 71        |             | CH12-107          | 107       |             |
| CH12-36           | 36        |             | CH12-72           | 72        |             | CH12-108          | 108       |             |
| CH12-37           | 37        |             | CH12-73           | 73        |             | CH12-109          | 109       |             |
| CH12-38           | 38        |             | CH12-74           | 74        |             | CH12-110          | 110       |             |
| CH12-39           | 39        |             | CH12-75           | 75        |             | CH12-111          | 111       |             |
| CH12-40           | 40        |             | CH12-76           | 76        |             | CH12-112          | 112       |             |
| CH12-41           | 41        |             | CH12-77           | 77        |             | CH12-113          | 113       |             |
| CH12-42           | 42        |             | CH12-78           | 78        |             | CH12-114          | 114       |             |
| CH12-43           | 43        |             | CH12-79           | 79        |             | CH12-115          | 115       |             |
| CH12-44           | 44        |             | CH12-80           | 80        |             | CH12-116          | 116       |             |
| CH12-45           | 45        |             | CH12-81           | 81        |             | CH12-117          | 117       |             |
| CH12-46           | 46        |             | CH12-82           | 82        |             | CH12-118          | 118       |             |
| CH12-47           | 47        |             | CH12-83           | 83        |             | CH12-119          | 119       |             |
| CH12-48           | 48        |             | CH12-84           | 84        |             | CH12-120          | 120       |             |
| CH12-49           | 49        |             | CH12-85           | 85        |             |                   |           |             |
| CH12-50           | 50        |             | CH12-86           | 86        |             |                   |           |             |

外径/Dia.31~



# CH03

外径/Dia.15~30



外径/Dia.31~

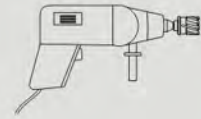

## 公制标准系列 Metric Regular Size :

<mm>

| 订货编号<br>Order NO. | 外径<br>Dia | 价格<br>Price | 订货编号<br>Order NO. | 外径<br>Dia | 价格<br>Price | 订货编号<br>Order NO. | 外径<br>Dia | 价格<br>Price |
|-------------------|-----------|-------------|-------------------|-----------|-------------|-------------------|-----------|-------------|
| CH03-15           | 15        |             | CH03-51           | 51        |             | CH03-87           | 87        |             |
| CH03-16           | 16        |             | CH03-52           | 52        |             | CH03-88           | 88        |             |
| CH03-17           | 17        |             | CH03-53           | 53        |             | CH03-89           | 89        |             |
| CH03-18           | 18        |             | CH03-54           | 54        |             | CH03-90           | 90        |             |
| CH03-19           | 19        |             | CH03-55           | 55        |             | CH03-91           | 91        |             |
| CH03-20           | 20        |             | CH03-56           | 56        |             | CH03-92           | 92        |             |
| CH03-21           | 21        |             | CH03-57           | 57        |             | CH03-93           | 93        |             |
| CH03-22           | 22        |             | CH03-58           | 58        |             | CH03-94           | 94        |             |
| CH03-23           | 23        |             | CH03-59           | 59        |             | CH03-95           | 95        |             |
| CH03-24           | 24        |             | CH03-60           | 60        |             | CH03-96           | 96        |             |
| CH03-25           | 25        |             | CH03-61           | 61        |             | CH03-97           | 97        |             |
| CH03-26           | 26        |             | CH03-62           | 62        |             | CH03-98           | 98        |             |
| CH03-27           | 27        |             | CH03-63           | 63        |             | CH03-99           | 99        |             |
| CH03-28           | 28        |             | CH03-64           | 64        |             | CH03-100          | 100       |             |
| CH03-29           | 29        |             | CH03-65           | 65        |             | CH03-101          | 101       |             |
| CH03-30           | 30        |             | CH03-66           | 66        |             | CH03-102          | 102       |             |
| CH03-31           | 31        |             | CH03-67           | 67        |             | CH03-103          | 103       |             |
| CH03-32           | 32        |             | CH03-68           | 68        |             | CH03-104          | 104       |             |
| CH03-33           | 33        |             | CH03-69           | 69        |             | CH03-105          | 105       |             |
| CH03-34           | 34        |             | CH03-70           | 70        |             | CH03-106          | 106       |             |
| CH03-35           | 35        |             | CH03-71           | 71        |             | CH03-107          | 107       |             |
| CH03-36           | 36        |             | CH03-72           | 72        |             | CH03-108          | 108       |             |
| CH03-37           | 37        |             | CH03-73           | 73        |             | CH03-109          | 109       |             |
| CH03-38           | 38        |             | CH03-74           | 74        |             | CH03-110          | 110       |             |
| CH03-39           | 39        |             | CH03-75           | 75        |             | CH03-111          | 111       |             |
| CH03-40           | 40        |             | CH03-76           | 76        |             | CH03-112          | 112       |             |
| CH03-41           | 41        |             | CH03-77           | 77        |             | CH03-113          | 113       |             |
| CH03-42           | 42        |             | CH03-78           | 78        |             | CH03-114          | 114       |             |
| CH03-43           | 43        |             | CH03-79           | 79        |             | CH03-115          | 115       |             |
| CH03-44           | 44        |             | CH03-80           | 80        |             | CH03-116          | 116       |             |
| CH03-45           | 45        |             | CH03-81           | 81        |             | CH03-117          | 117       |             |
| CH03-46           | 46        |             | CH03-82           | 82        |             | CH03-118          | 118       |             |
| CH03-47           | 47        |             | CH03-83           | 83        |             | CH03-119          | 119       |             |
| CH03-48           | 48        |             | CH03-84           | 84        |             | CH03-120          | 120       |             |
| CH03-49           | 49        |             | CH03-85           | 85        |             |                   |           |             |
| CH03-50           | 50        |             | CH03-86           | 86        |             |                   |           |             |



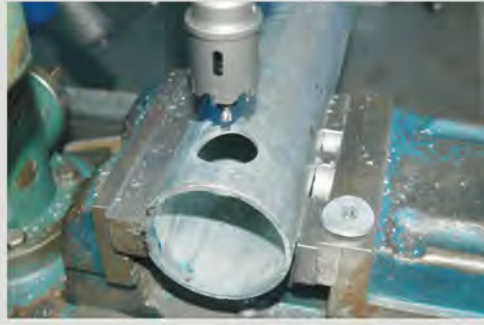
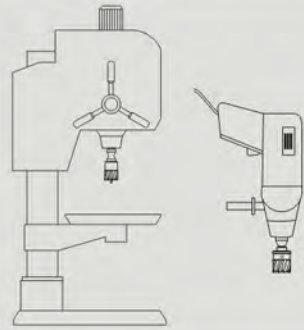

公制标准系列 Metric Regular Size :

<mm>

| 订货编号<br>Order NO. | 外径<br>Dia | 价格<br>Price | 订货编号<br>Order NO. | 外径<br>Dia | 价格<br>Price | 订货编号<br>Order NO. | 外径<br>Dia | 价格<br>Price |
|-------------------|-----------|-------------|-------------------|-----------|-------------|-------------------|-----------|-------------|
| CHP03-20          | 20        |             | CHP03-47          | 47        |             | CHP03-74          | 74        |             |
| CHP03-21          | 21        |             | CHP03-48          | 48        |             | CHP03-75          | 75        |             |
| CHP03-22          | 22        |             | CHP03-49          | 49        |             | CHP03-76          | 76        |             |
| CHP03-23          | 23        |             | CHP03-50          | 50        |             | CHP03-77          | 77        |             |
| CHP03-24          | 24        |             | CHP03-51          | 51        |             | CHP03-78          | 78        |             |
| CHP03-25          | 25        |             | CHP03-52          | 52        |             | CHP03-79          | 79        |             |
| CHP03-26          | 26        |             | CHP03-53          | 53        |             | CHP03-80          | 80        |             |
| CHP03-27          | 27        |             | CHP03-54          | 54        |             | CHP03-81          | 81        |             |
| CHP03-28          | 28        |             | CHP03-55          | 55        |             | CHP03-82          | 82        |             |
| CHP03-29          | 29        |             | CHP03-56          | 56        |             | CHP03-83          | 83        |             |
| CHP03-30          | 30        |             | CHP03-57          | 57        |             | CHP03-84          | 84        |             |
| CHP03-31          | 31        |             | CHP03-58          | 58        |             | CHP03-85          | 85        |             |
| CHP03-32          | 32        |             | CHP03-59          | 59        |             | CHP03-86          | 86        |             |
| CHP03-33          | 33        |             | CHP03-60          | 60        |             | CHP03-87          | 87        |             |
| CHP03-34          | 34        |             | CHP03-61          | 61        |             | CHP03-88          | 88        |             |
| CHP03-35          | 35        |             | CHP03-62          | 62        |             | CHP03-89          | 89        |             |
| CHP03-36          | 36        |             | CHP03-63          | 63        |             | CHP03-90          | 90        |             |
| CHP03-37          | 37        |             | CHP03-64          | 64        |             | CHP03-91          | 91        |             |
| CHP03-38          | 38        |             | CHP03-65          | 65        |             | CHP03-92          | 92        |             |
| CHP03-39          | 39        |             | CHP03-66          | 66        |             | CHP03-93          | 93        |             |
| CHP03-40          | 40        |             | CHP03-67          | 67        |             | CHP03-94          | 94        |             |
| CHP03-41          | 41        |             | CHP03-68          | 68        |             | CHP03-95          | 95        |             |
| CHP03-42          | 42        |             | CHP03-69          | 69        |             | CHP03-96          | 96        |             |
| CHP03-43          | 43        |             | CHP03-70          | 70        |             | CHP03-97          | 97        |             |
| CHP03-44          | 44        |             | CHP03-71          | 71        |             | CHP03-98          | 98        |             |
| CHP03-45          | 45        |             | CHP03-72          | 72        |             | CHP03-99          | 99        |             |
| CHP03-46          | 46        |             | CHP03-73          | 73        |             | CHP03-100         | 100       |             |

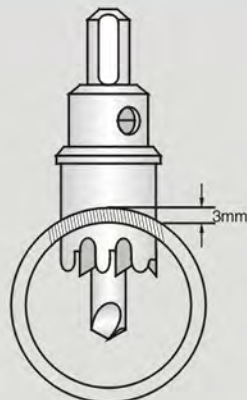

# CHP03

外径/Dia.20~30



外径/Dia.31~



ICF1"



ICF1"S

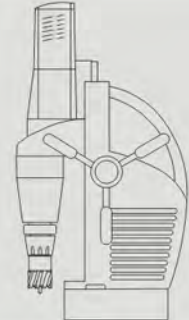

英制标准系列 Inch Regular Size:

<inch>

| 订货编号<br>Order NO. | 外径<br>Dia | 价格<br>Price | 订货编号<br>Order NO. | 外径<br>Dia | 价格<br>Price |
|-------------------|-----------|-------------|-------------------|-----------|-------------|
| ICF1"S-01         | 1/2       |             | ICF1"S-18         | 1-9/16    |             |
| ICF1"S-02         | 9/16      |             | ICF1"S-19         | 1-5/8     |             |
| ICF1"S-03         | 5/8       |             | ICF1"S-20         | 1-11/16   |             |
| ICF1"S-04         | 11/16     |             | ICF1"S-21         | 1-3/4     |             |
| ICF1"S-05         | 3/4       |             | ICF1"S-22         | 1-13/16   |             |
| ICF1"S-06         | 13/16     |             | ICF1"S-23         | 1-7/8     |             |
| ICF1"S-07         | 7/8       |             | ICF1"S-24         | 1-15/16   |             |
| ICF1"S-08         | 15/16     |             | ICF1"S-25         | 2         |             |
| ICF1"S-09         | 1         |             | ICF1"S-26         | 2-1/16    |             |
| ICF1"S-10         | 1-1/16    |             | ICF1"S-27         | 2-1/8     |             |
| ICF1"S-11         | 1-1/8     |             | ICF1"S-28         | 2-3/16    |             |
| ICF1"S-12         | 1-3/16    |             | ICF1"S-29         | 2-1/4     |             |
| ICF1"S-13         | 1-1/4     |             | ICF1"S-30         | 2-5/16    |             |
| ICF1"S-14         | 1-5/16    |             | ICF1"S-31         | 2-3/8     |             |
| ICF1"S-15         | 1-3/8     |             | ICF1"S-32         | 2-7/16    |             |
| ICF1"S-16         | 1-7/16    |             | ICF1"S-33         | 2-1/2     |             |
| ICF1"S-17         | 1-1/2     |             |                   |           |             |

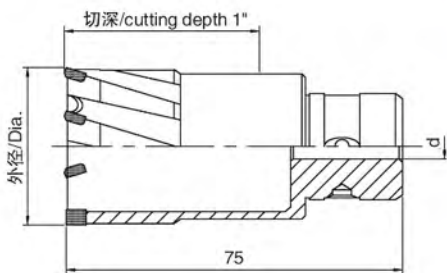

φ6.35x90 适用于直径1/2"—2-1/2"的钢板钻  
Suitable for diameter from 1/2"—2-1/2"

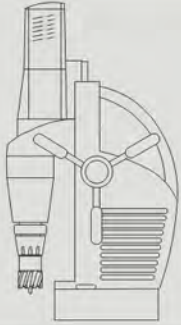

# ICF2"



ICF2"S

英制标准系列 Inch Regular Size:

<inch>

| 订货编号<br>Order NO. | 外径<br>Dia | 价格<br>Price | 订货编号<br>Order NO. | 外径<br>Dia | 价格<br>Price |
|-------------------|-----------|-------------|-------------------|-----------|-------------|
| ICF2"S-01         | 1/2       |             | ICF2"S-18         | 1-9/16    |             |
| ICF2"S-02         | 9/16      |             | ICF2"S-19         | 1-5/8     |             |
| ICF2"S-03         | 5/8       |             | ICF2"S-20         | 1-11/16   |             |
| ICF2"S-04         | 11/16     |             | ICF2"S-21         | 1-3/4     |             |
| ICF2"S-05         | 3/4       |             | ICF2"S-22         | 1-13/16   |             |
| ICF2"S-06         | 13/16     |             | ICF2"S-23         | 1-7/8     |             |
| ICF2"S-07         | 7/8       |             | ICF2"S-24         | 1-15/16   |             |
| ICF2"S-08         | 15/16     |             | ICF2"S-25         | 2         |             |
| ICF2"S-09         | 1         |             | ICF2"S-26         | 2-1/16    |             |
| ICF2"S-10         | 1-1/16    |             | ICF2"S-27         | 2-1/8     |             |
| ICF2"S-11         | 1-1/8     |             | ICF2"S-28         | 2-3/16    |             |
| ICF2"S-12         | 1-3/16    |             | ICF2"S-29         | 2-1/4     |             |
| ICF2"S-13         | 1-1/4     |             | ICF2"S-30         | 2-5/16    |             |
| ICF2"S-14         | 1-5/16    |             | ICF2"S-31         | 2-3/8     |             |
| ICF2"S-15         | 1-3/8     |             | ICF2"S-32         | 2-7/16    |             |
| ICF2"S-16         | 1-7/16    |             | ICF2"S-33         | 2-1/2     |             |
| ICF2"S-17         | 1-1/2     |             |                   |           |             |

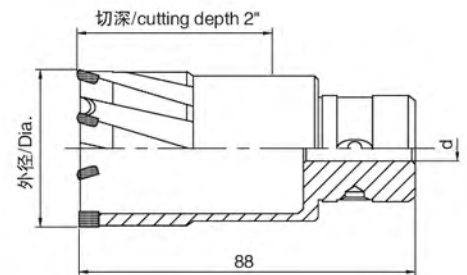

φ 6.35x105 适用于直径 1/2"—2-1/2" 的钢板钻  
Suitable for diameter from 1/2"—2-1/2"

# ICU1"



ICU1"S



ICU1"L

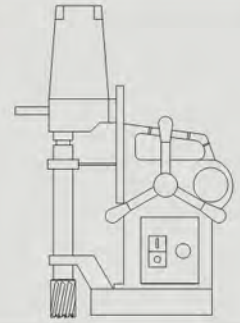

英制标准系列 Inch Regular Size :

<inch>

| 订货编号<br>Order NO. | 外径<br>Dia | 价格<br>Price | 订货编号<br>Order NO. | 外径<br>Dia | 价格<br>Price |
|-------------------|-----------|-------------|-------------------|-----------|-------------|
| ICU1"S/L-01       | 1/2       |             | ICU1"S/L-18       | 1-9/16    |             |
| ICU1"S/L-02       | 9/16      |             | ICU1"S/L-19       | 1-5/8     |             |
| ICU1"S/L-03       | 5/8       |             | ICU1"S/L-20       | 1-11/16   |             |
| ICU1"S/L-04       | 11/16     |             | ICU1"S/L-21       | 1-3/4     |             |
| ICU1"S/L-05       | 3/4       |             | ICU1"S/L-22       | 1-13/16   |             |
| ICU1"S/L-06       | 13/16     |             | ICU1"S/L-23       | 1-7/8     |             |
| ICU1"S/L-07       | 7/8       |             | ICU1"S/L-24       | 1-15/16   |             |
| ICU1"S/L-08       | 15/16     |             | ICU1"S/L-25       | 2         |             |
| ICU1"S/L-09       | 1         |             | ICU1"S/L-26       | 2-1/16    |             |
| ICU1"S/L-10       | 1-1/16    |             | ICU1"S/L-27       | 2-1/8     |             |
| ICU1"S/L-11       | 1-1/8     |             | ICU1"S/L-28       | 2-3/16    |             |
| ICU1"S/L-12       | 1-3/16    |             | ICU1"S/L-29       | 2-1/4     |             |
| ICU1"S/L-13       | 1-1/4     |             | ICU1"S/L-30       | 2-5/16    |             |
| ICU1"S/L-14       | 1-5/16    |             | ICU1"S/L-31       | 2-3/8     |             |
| ICU1"S/L-15       | 1-3/8     |             | ICU1"S/L-32       | 2-7/16    |             |
| ICU1"S/L-16       | 1-7/16    |             | ICU1"S/L-33       | 2-1/2     |             |
| ICU1"S/L-17       | 1-1/2     |             |                   |           |             |

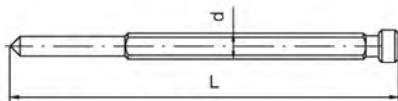
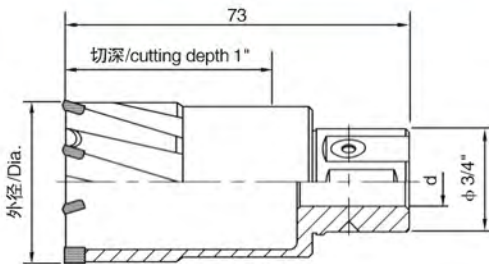

φ 6.35x90 适用于直径1/2"—11/16"的钢板钻  
Suitable for diameter from 1/2" to 11/16"



φ 8x90 适用于直径3/4"—2-1/2"mm的钢板钻  
Suitable for diameter from 3/4" to 2-1/2"

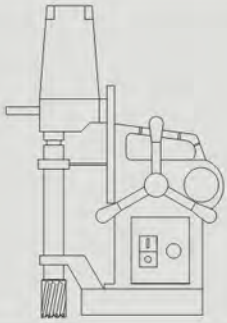

英制标准系列 Inch Regular Size:

<inch>

| 订货编号<br>Order NO. | 外径<br>Dia | 价格<br>Price | 订货编号<br>Order NO. | 外径<br>Dia | 价格<br>Price |
|-------------------|-----------|-------------|-------------------|-----------|-------------|
| ICU2*S/L-01       | 1/2       |             | ICU2*S/L-18       | 1-9/16    |             |
| ICU2*S/L-02       | 9/16      |             | ICU2*S/L-19       | 1-5/8     |             |
| ICU2*S/L-03       | 5/8       |             | ICU2*S/L-20       | 1-11/16   |             |
| ICU2*S/L-04       | 11/16     |             | ICU2*S/L-21       | 1-3/4     |             |
| ICU2*S/L-05       | 3/4       |             | ICU2*S/L-22       | 1-13/16   |             |
| ICU2*S/L-06       | 13/16     |             | ICU2*S/L-23       | 1-7/8     |             |
| ICU2*S/L-07       | 7/8       |             | ICU2*S/L-24       | 1-15/16   |             |
| ICU2*S/L-08       | 15/16     |             | ICU2*S/L-25       | 2         |             |
| ICU2*S/L-09       | 1         |             | ICU2*S/L-26       | 2-1/16    |             |
| ICU2*S/L-10       | 1-1/16    |             | ICU2*S/L-27       | 2-1/8     |             |
| ICU2*S/L-11       | 1-1/8     |             | ICU2*S/L-28       | 2-3/16    |             |
| ICU2*S/L-12       | 1-3/16    |             | ICU2*S/L-29       | 2-1/4     |             |
| ICU2*S/L-13       | 1-1/4     |             | ICU2*S/L-30       | 2-5/16    |             |
| ICU2*S/L-14       | 1-5/16    |             | ICU2*S/L-31       | 2-3/8     |             |
| ICU2*S/L-15       | 1-3/8     |             | ICU2*S/L-32       | 2-7/16    |             |
| ICU2*S/L-16       | 1-7/16    |             | ICU2*S/L-33       | 2-1/2     |             |
| ICU2*S/L-17       | 1-1/2     |             |                   |           |             |

# ICU2"



ICU2"S



ICU2"L

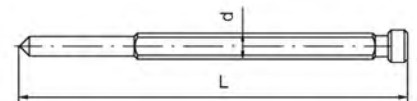
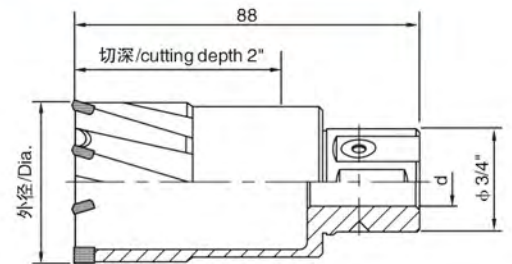

φ 6.35x105 适用于直径 1/2" — 11/16" 的钢板钻  
Suitable for diameter from 1/2" to 11/16"

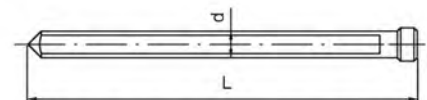

φ 8x105 适用于直径 3/4" — 2-1/2" 的钢板钻  
Suitable for diameter from 3/4" to 2-1/2"

# ICW1"



ICW1"S



ICW1"L

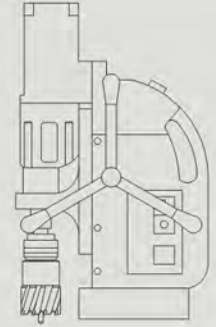

英制标准系列 Inch Regular Size :

<inch>

| 订货编号<br>Order NO. | 外径<br>Dia | 价格<br>Price | 订货编号<br>Order NO. | 外径<br>Dia | 价格<br>Price |
|-------------------|-----------|-------------|-------------------|-----------|-------------|
| ICW1"S/L-01       | 1/2       |             | ICW1"S/L-30       | 2-5/16    |             |
| ICW1"S/L-02       | 9/16      |             | ICW1"S/L-31       | 2-3/8     |             |
| ICW1"S/L-03       | 5/8       |             | ICW1"S/L-32       | 2-7/16    |             |
| ICW1"S/L-04       | 11/16     |             | ICW1"S/L-33       | 2-1/2     |             |
| ICW1"S/L-05       | 3/4       |             | ICW1"S/L-34       | 2-9/16    |             |
| ICW1"S/L-06       | 13/16     |             | ICW1"S/L-35       | 2-5/8     |             |
| ICW1"S/L-07       | 7/8       |             | ICW1"S/L-36       | 2-11/16   |             |
| ICW1"S/L-08       | 15/16     |             | ICW1"S/L-37       | 2-3/4     |             |
| ICW1"S/L-09       | 1         |             | ICW1"S/L-38       | 2-13/16   |             |
| ICW1"S/L-10       | 1-1/16    |             | ICW1"S/L-39       | 2-7/8     |             |
| ICW1"S/L-11       | 1-1/8     |             | ICW1"S/L-40       | 2-15/16   |             |
| ICW1"S/L-12       | 1-3/16    |             | ICW1"S/L-41       | 3         |             |
| ICW1"S/L-13       | 1-1/4     |             | ICW1"S/L-42       | 3-1/16    |             |
| ICW1"S/L-14       | 1-5/16    |             | ICW1"S/L-43       | 3-1/8     |             |
| ICW1"S/L-15       | 1-3/8     |             | ICW1"S/L-44       | 3-3/16    |             |
| ICW1"S/L-16       | 1-7/16    |             | ICW1"S/L-45       | 3-1/4     |             |
| ICW1"S/L-17       | 1-1/2     |             | ICW1"S/L-46       | 3-5/16    |             |
| ICW1"S/L-18       | 1-9/16    |             | ICW1"S/L-47       | 3-3/8     |             |
| ICW1"S/L-19       | 1-5/8     |             | ICW1"S/L-48       | 3-7/16    |             |
| ICW1"S/L-20       | 1-11/16   |             | ICW1"S/L-49       | 3-1/2     |             |
| ICW1"S/L-21       | 1-3/4     |             | ICW1"S/L-50       | 3-9/16    |             |
| ICW1"S/L-22       | 1-13/16   |             | ICW1"S/L-51       | 3-5/8     |             |
| ICW1"S/L-23       | 1-7/8     |             | ICW1"S/L-52       | 3-11/16   |             |
| ICW1"S/L-24       | 1-15/16   |             | ICW1"S/L-53       | 3-3/4     |             |
| ICW1"S/L-25       | 2         |             | ICW1"S/L-54       | 3-13/16   |             |
| ICW1"S/L-26       | 2-1/16    |             | ICW1"S/L-55       | 3-7/8     |             |
| ICW1"S/L-27       | 2-1/8     |             | ICW1"S/L-56       | 3-15/16   |             |
| ICW1"S/L-28       | 2-3/16    |             | ICW1"S/L-57       | 4         |             |
| ICW1"S/L-29       | 2-1/4     |             |                   |           |             |

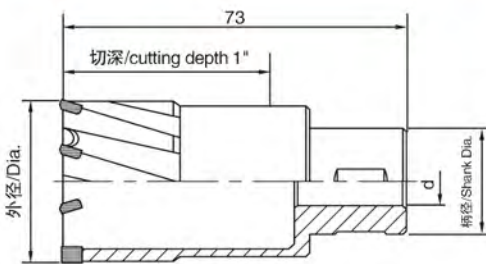

柄径/Shank Dia.:

外径/Dia. 1/2"~2-1/2"

柄径/Shank Dia. 3/4"

外径/Dia. 2-9/16"~

柄径/Shank Dia. 1-1/4"

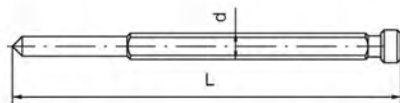

φ 6.35x90 适用于直径1/2"—11/16"的钢板钻  
Suitable for diameter from 1/2" to 11/16"

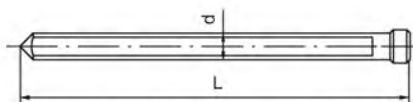

φ 8x90 适用于直径3/4"—4"的钢板钻  
Suitable for diameter from 3/4" to 4"

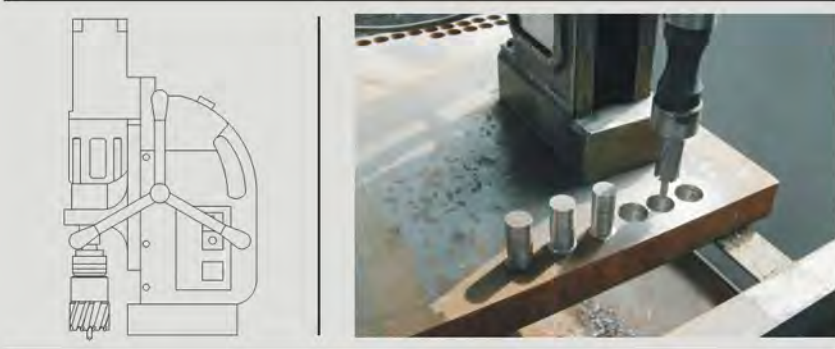

英制标准系列 Inch Regular Size:

<inch>

| 订货编号<br>Order NO. | 外径<br>Dia | 价格<br>Price | 订货编号<br>Order NO. | 外径<br>Dia | 价格<br>Price |
|-------------------|-----------|-------------|-------------------|-----------|-------------|
| ICW2*S/L-01       | 1/2       |             | ICW2*S/L-30       | 2-5/16    |             |
| ICW2*S/L-02       | 9/16      |             | ICW2*S/L-31       | 2-3/8     |             |
| ICW2*S/L-03       | 5/8       |             | ICW2*S/L-32       | 2-7/16    |             |
| ICW2*S/L-04       | 11/16     |             | ICW2*S/L-33       | 2-1/2     |             |
| ICW2*S/L-05       | 3/4       |             | ICW2*S/L-34       | 2-9/16    |             |
| ICW2*S/L-06       | 13/16     |             | ICW2*S/L-35       | 2-5/8     |             |
| ICW2*S/L-07       | 7/8       |             | ICW2*S/L-36       | 2-11/16   |             |
| ICW2*S/L-08       | 15/16     |             | ICW2*S/L-37       | 2-3/4     |             |
| ICW2*S/L-09       | 1         |             | ICW2*S/L-38       | 2-13/16   |             |
| ICW2*S/L-10       | 1-1/16    |             | ICW2*S/L-39       | 2-7/8     |             |
| ICW2*S/L-11       | 1-1/8     |             | ICW2*S/L-40       | 2-15/16   |             |
| ICW2*S/L-12       | 1-3/16    |             | ICW2*S/L-41       | 3         |             |
| ICW2*S/L-13       | 1-1/4     |             | ICW2*S/L-42       | 3-1/16    |             |
| ICW2*S/L-14       | 1-5/16    |             | ICW2*S/L-43       | 3-1/8     |             |
| ICW2*S/L-15       | 1-3/8     |             | ICW2*S/L-44       | 3-3/16    |             |
| ICW2*S/L-16       | 1-7/16    |             | ICW2*S/L-45       | 3-1/4     |             |
| ICW2*S/L-17       | 1-1/2     |             | ICW2*S/L-46       | 3-5/16    |             |
| ICW2*S/L-18       | 1-9/16    |             | ICW2*S/L-47       | 3-3/8     |             |
| ICW2*S/L-19       | 1-5/8     |             | ICW2*S/L-48       | 3-7/16    |             |
| ICW2*S/L-20       | 1-11/16   |             | ICW2*S/L-49       | 3-1/2     |             |
| ICW2*S/L-21       | 1-3/4     |             | ICW2*S/L-50       | 3-9/16    |             |
| ICW2*S/L-22       | 1-13/16   |             | ICW2*S/L-51       | 3-5/8     |             |
| ICW2*S/L-23       | 1-7/8     |             | ICW2*S/L-52       | 3-11/16   |             |
| ICW2*S/L-24       | 1-15/16   |             | ICW2*S/L-53       | 3-3/4     |             |
| ICW2*S/L-25       | 2         |             | ICW2*S/L-54       | 3-13/16   |             |
| ICW2*S/L-26       | 2-1/16    |             | ICW2*S/L-55       | 3-7/8     |             |
| ICW2*S/L-27       | 2-1/8     |             | ICW2*S/L-56       | 3-15/16   |             |
| ICW2*S/L-28       | 2-3/16    |             | ICW2*S/L-57       | 4         |             |
| ICW2*S/L-29       | 2-1/4     |             |                   |           |             |

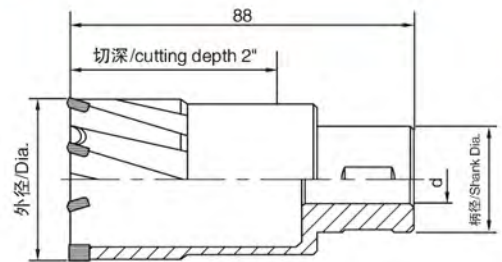

柄径/Shank Dia.:  
 外径/Dia. 1/2"~2-1/2"    柄径/Shank Dia. 3/4"  
 外径/Dia. 2-9/16"~    柄径/Shank Dia. 1-1/4"

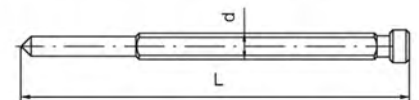

φ6.35x105 适用于直径1/2"—11/16"的钢板钻  
 Suitable for diameter from 1/2" to 11/16"

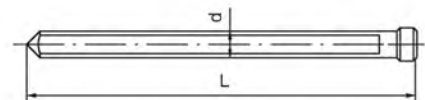

φ8x105 适用于直径3/4"—4"的钢板钻  
 Suitable for diameter from 3/4" to 4"

ICT2"



ICT2"S



ICT2"S

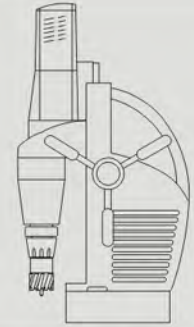

英制标准系列 Inch Regular Size :

<inch>

| 订货编号<br>Order NO. | 外径<br>Dia | 价格<br>Price | 订货编号<br>Order NO. | 外径<br>Dia | 价格<br>Price |
|-------------------|-----------|-------------|-------------------|-----------|-------------|
| ICT2"S-01         | 1/2       |             | ICT2"S-30         | 2-5/16    |             |
| ICT2"S-02         | 9/16      |             | ICT2"S-31         | 2-3/8     |             |
| ICT2"S-03         | 5/8       |             | ICT2"S-32         | 2-7/16    |             |
| ICT2"S-04         | 11/16     |             | ICT2"S-33         | 2-1/2     |             |
| ICT2"S-05         | 3/4       |             | ICT2"S-34         | 2-9/16    |             |
| ICT2"S-06         | 13/16     |             | ICT2"S-35         | 2-5/8     |             |
| ICT2"S-07         | 7/8       |             | ICT2"S-36         | 2-11/16   |             |
| ICT2"S-08         | 15/16     |             | ICT2"S-37         | 2-3/4     |             |
| ICT2"S-09         | 1         |             | ICT2"S-38         | 2-13/16   |             |
| ICT2"S-10         | 1-1/16    |             | ICT2"S-39         | 2-7/8     |             |
| ICT2"S-11         | 1-1/8     |             | ICT2"S-40         | 2-15/16   |             |
| ICT2"S-12         | 1-3/16    |             | ICT2"S-41         | 3         |             |
| ICT2"S-13         | 1-1/4     |             | ICT2"S-42         | 3-1/16    |             |
| ICT2"S-14         | 1-5/16    |             | ICT2"S-43         | 3-1/8     |             |
| ICT2"S-15         | 1-3/8     |             | ICT2"S-44         | 3-3/16    |             |
| ICT2"S-16         | 1-7/16    |             | ICT2"S-45         | 3-1/4     |             |
| ICT2"S-17         | 1-1/2     |             | ICT2"S-46         | 3-5/16    |             |
| ICT2"S-18         | 1-9/16    |             | ICT2"S-47         | 3-3/8     |             |
| ICT2"S-19         | 1-5/8     |             | ICT2"S-48         | 3-7/16    |             |
| ICT2"S-20         | 1-11/16   |             | ICT2"S-49         | 3-1/2     |             |
| ICT2"S-21         | 1-3/4     |             | ICT2"S-50         | 3-9/16    |             |
| ICT2"S-22         | 1-13/16   |             | ICT2"S-51         | 3-5/8     |             |
| ICT2"S-23         | 1-7/8     |             | ICT2"S-52         | 3-11/16   |             |
| ICT2"S-24         | 1-15/16   |             | ICT2"S-53         | 3-3/4     |             |
| ICT2"S-25         | 2         |             | ICT2"S-54         | 3-13/16   |             |
| ICT2"S-26         | 2-1/16    |             | ICT2"S-55         | 3-7/8     |             |
| ICT2"S-27         | 2-1/8     |             | ICT2"S-56         | 3-15/16   |             |
| ICT2"S-28         | 2-3/16    |             | ICT2"S-57         | 4         |             |
| ICT2"S-29         | 2-1/4     |             |                   |           |             |



削平柄钢轨钻/切深1"或2"

Rail Cutting Core Drills with Weldon Shank/Cutting depth 1" or 2"



| 硬 | 锋 | 工 | 具 |

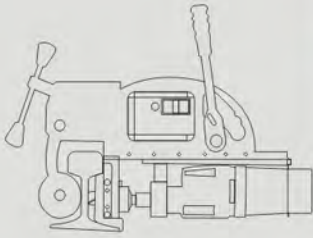

英制标准系列 Inch Regular Size:

<inch>

| 订货编号<br>Order NO. | 外径<br>Dia | 价格<br>Price | 订货编号<br>Order NO. | 外径<br>Dia | 价格<br>Price |
|-------------------|-----------|-------------|-------------------|-----------|-------------|
| ICWR1"S-01        | 13/16     |             | ICWR2"S-01        | 13/16     |             |
| ICWR1"S-02        | 7/8       |             | ICWR2"S-02        | 7/8       |             |
| ICWR1"S-03        | 15/16     |             | ICWR2"S-03        | 15/16     |             |
| ICWR1"S-04        | 1         |             | ICWR2"S-04        | 1         |             |
| ICWR1"S-05        | 1-1/16    |             | ICWR2"S-05        | 1-1/16    |             |
| ICWR1"S-06        | 1-1/8     |             | ICWR2"S-06        | 1-1/8     |             |
| ICWR1"S-07        | 1-3/16    |             | ICWR2"S-07        | 1-3/16    |             |
| ICWR1"S-08        | 1-1/4     |             | ICWR2"S-08        | 1-1/4     |             |
| ICWR1"S-09        | 1-5/16    |             | ICWR2"S-09        | 1-5/16    |             |
| ICWR1"S-10        | 1-3/8     |             | ICWR2"S-10        | 1-3/8     |             |
| ICWR1"S-11        | 1-7/16    |             | ICWR2"S-11        | 1-7/16    |             |

英制标准系列 Inch Regular Size:

<inch>

| 订货编号<br>Order NO. | 外径<br>Dia | 价格<br>Price | 订货编号<br>Order NO. | 外径<br>Dia | 价格<br>Price |
|-------------------|-----------|-------------|-------------------|-----------|-------------|
| IHWR1"L-01        | 13/16     |             | IHWR2"L-01        | 13/16     |             |
| IHWR1"L-02        | 7/8       |             | IHWR2"L-02        | 7/8       |             |
| IHWR1"L-03        | 15/16     |             | IHWR2"L-03        | 15/16     |             |
| IHWR1"L-04        | 1         |             | IHWR2"L-04        | 1         |             |
| IHWR1"L-05        | 1-1/16    |             | IHWR2"L-05        | 1-1/16    |             |
| IHWR1"L-06        | 1-1/8     |             | IHWR2"L-06        | 1-1/8     |             |
| IHWR1"L-07        | 1-3/16    |             | IHWR2"L-07        | 1-3/16    |             |
| IHWR1"L-08        | 1-1/4     |             | IHWR2"L-08        | 1-1/4     |             |
| IHWR1"L-09        | 1-5/16    |             | IHWR2"L-09        | 1-5/16    |             |
| IHWR1"L-10        | 1-3/8     |             | IHWR2"L-10        | 1-3/8     |             |
| IHWR1"L-11        | 1-7/16    |             | IHWR2"L-11        | 1-7/16    |             |

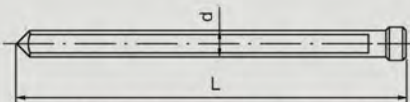

φ8x90 适用于直径13/16"—1-7/16"的钢轨钻  
Suitable for diameter from 13/16"—1-7/16"

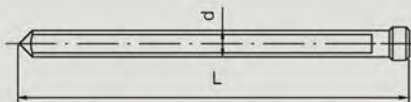

φ8x105 适用于直径13/16"—1-7/16"的钢轨钻  
Suitable for diameter from 13/16"—1-7/16"

ICWR1"  
ICWR2"



ICWR1"S  
ICWR2"S

IHWR1"  
IHWR2"



IHWR1"L  
IHWR2"L

# ICH1"

外径/Dia.5/8" ~1-3/16"



外径/Dia.1-1/4" ~



## 英制标准系列 Inch Regular Size :

<inch>

| 订货编号<br>Order NO. | 外径<br>Dia | 价格<br>Price | 订货编号<br>Order NO. | 外径<br>Dia | 价格<br>Price |
|-------------------|-----------|-------------|-------------------|-----------|-------------|
| ICH1"-01          | 5/8       |             | ICH1"-29          | 2-3/8     |             |
| ICH1"-02          | 11/16     |             | ICH1"-30          | 2-7/16    |             |
| ICH1"-03          | 3/4       |             | ICH1"-31          | 2-1/2     |             |
| ICH1"-04          | 13/16     |             | ICH1"-32          | 2-9/16    |             |
| ICH1"-05          | 7/8       |             | ICH1"-33          | 2-5/8     |             |
| ICH1"-06          | 15/16     |             | ICH1"-34          | 2-11/16   |             |
| ICH1"-07          | 1         |             | ICH1"-35          | 2-3/4     |             |
| ICH1"-08          | 1-1/16    |             | ICH1"-36          | 2-13/16   |             |
| ICH1"-09          | 1-1/8     |             | ICH1"-37          | 2-7/8     |             |
| ICH1"-10          | 1-3/16    |             | ICH1"-38          | 2-15/16   |             |
| ICH1"-11          | 1-1/4     |             | ICH1"-39          | 3         |             |
| ICH1"-12          | 1-5/16    |             | ICH1"-40          | 3-1/16    |             |
| ICH1"-13          | 1-3/8     |             | ICH1"-41          | 3-1/8     |             |
| ICH1"-14          | 1-7/16    |             | ICH1"-42          | 3-3/16    |             |
| ICH1"-15          | 1-1/2     |             | ICH1"-43          | 3-1/4     |             |
| ICH1"-16          | 1-9/16    |             | ICH1"-44          | 3-5/16    |             |
| ICH1"-17          | 1-5/8     |             | ICH1"-45          | 3-3/8     |             |
| ICH1"-18          | 1-11/16   |             | ICH1"-46          | 3-7/16    |             |
| ICH1"-19          | 1-3/4     |             | ICH1"-47          | 3-1/2     |             |
| ICH1"-20          | 1-13/16   |             | ICH1"-48          | 3-9/16    |             |
| ICH1"-21          | 1-7/8     |             | ICH1"-49          | 3-5/8     |             |
| ICH1"-22          | 1-15/16   |             | ICH1"-50          | 3-11/16   |             |
| ICH1"-23          | 2         |             | ICH1"-51          | 3-3/4     |             |
| ICH1"-24          | 2-1/16    |             | ICH1"-52          | 3-13/16   |             |
| ICH1"-25          | 2-1/8     |             | ICH1"-53          | 3-7/8     |             |
| ICH1"-26          | 2-3/16    |             | ICH1"-54          | 3-15/16   |             |
| ICH1"-27          | 2-1/4     |             | ICH1"-55          | 4         |             |
| ICH1"-28          | 2-5/16    |             |                   |           |             |



# ICH1/2"

外径/Dia.5/8" ~1-3/16"



英制标准系列 Inch Regular Size:

<inch>

| 订货编号<br>Order NO. | 外径<br>Dia | 价格<br>Price | 订货编号<br>Order NO. | 外径<br>Dia | 价格<br>Price |
|-------------------|-----------|-------------|-------------------|-----------|-------------|
| ICH1/2"-01        | 5/8       |             | ICH1/2"-29        | 2-3/8     |             |
| ICH1/2"-02        | 11/16     |             | ICH1/2"-30        | 2-7/16    |             |
| ICH1/2"-03        | 3/4       |             | ICH1/2"-31        | 2-1/2     |             |
| ICH1/2"-04        | 13/16     |             | ICH1/2"-32        | 2-9/16    |             |
| ICH1/2"-05        | 7/8       |             | ICH1/2"-33        | 2-5/8     |             |
| ICH1/2"-06        | 15/16     |             | ICH1/2"-34        | 2-11/16   |             |
| ICH1/2"-07        | 1         |             | ICH1/2"-35        | 2-3/4     |             |
| ICH1/2"-08        | 1-1/16    |             | ICH1/2"-36        | 2-13/16   |             |
| ICH1/2"-09        | 1-1/8     |             | ICH1/2"-37        | 2-7/8     |             |
| ICH1/2"-10        | 1-3/16    |             | ICH1/2"-38        | 2-15/16   |             |
| ICH1/2"-11        | 1-1/4     |             | ICH1/2"-39        | 3         |             |
| ICH1/2"-12        | 1-5/16    |             | ICH1/2"-40        | 3-1/16    |             |
| ICH1/2"-13        | 1-3/8     |             | ICH1/2"-41        | 3-1/8     |             |
| ICH1/2"-14        | 1-7/16    |             | ICH1/2"-42        | 3-3/16    |             |
| ICH1/2"-15        | 1-1/2     |             | ICH1/2"-43        | 3-1/4     |             |
| ICH1/2"-16        | 1-9/16    |             | ICH1/2"-44        | 3-5/16    |             |
| ICH1/2"-17        | 1-5/8     |             | ICH1/2"-45        | 3-3/8     |             |
| ICH1/2"-18        | 1-11/16   |             | ICH1/2"-46        | 3-7/16    |             |
| ICH1/2"-19        | 1-3/4     |             | ICH1/2"-47        | 3-1/2     |             |
| ICH1/2"-20        | 1-13/16   |             | ICH1/2"-48        | 3-9/16    |             |
| ICH1/2"-21        | 1-7/8     |             | ICH1/2"-49        | 3-5/8     |             |
| ICH1/2"-22        | 1-15/16   |             | ICH1/2"-50        | 3-11/16   |             |
| ICH1/2"-23        | 2         |             | ICH1/2"-51        | 3-3/4     |             |
| ICH1/2"-24        | 2-1/16    |             | ICH1/2"-52        | 3-13/16   |             |
| ICH1/2"-25        | 2-1/8     |             | ICH1/2"-53        | 3-7/8     |             |
| ICH1/2"-26        | 2-3/16    |             | ICH1/2"-54        | 3-15/16   |             |
| ICH1/2"-27        | 2-1/4     |             | ICH1/2"-55        | 4         |             |
| ICH1/2"-28        | 2-5/16    |             |                   |           |             |

外径/Dia.1-1/4" ~



# ICH1/8"

外径/Dia.5/8" ~1-3/16"



## 英制标准系列 Inch Regular Size :

<inch>

| 订货编号<br>Order NO. | 外径<br>Dia | 价格<br>Price | 订货编号<br>Order NO. | 外径<br>Dia | 价格<br>Price |
|-------------------|-----------|-------------|-------------------|-----------|-------------|
| ICH1/8"-01        | 5/8       |             | ICH1/8"-29        | 2-3/8     |             |
| ICH1/8"-02        | 11/16     |             | ICH1/8"-30        | 2-7/16    |             |
| ICH1/8"-03        | 3/4       |             | ICH1/8"-31        | 2-1/2     |             |
| ICH1/8"-04        | 13/16     |             | ICH1/8"-32        | 2-9/16    |             |
| ICH1/8"-05        | 7/8       |             | ICH1/8"-33        | 2-5/8     |             |
| ICH1/8"-06        | 15/16     |             | ICH1/8"-34        | 2-11/16   |             |
| ICH1/8"-07        | 1         |             | ICH1/8"-35        | 2-3/4     |             |
| ICH1/8"-08        | 1-1/16    |             | ICH1/8"-36        | 2-13/16   |             |
| ICH1/8"-09        | 1-1/8     |             | ICH1/8"-37        | 2-7/8     |             |
| ICH1/8"-10        | 1-3/16    |             | ICH1/8"-38        | 2-15/16   |             |
| ICH1/8"-11        | 1-1/4     |             | ICH1/8"-39        | 3         |             |
| ICH1/8"-12        | 1-5/16    |             | ICH1/8"-40        | 3-1/16    |             |
| ICH1/8"-13        | 1-3/8     |             | ICH1/8"-41        | 3-1/8     |             |
| ICH1/8"-14        | 1-7/16    |             | ICH1/8"-42        | 3-3/16    |             |
| ICH1/8"-15        | 1-1/2     |             | ICH1/8"-43        | 3-1/4     |             |
| ICH1/8"-16        | 1-9/16    |             | ICH1/8"-44        | 3-5/16    |             |
| ICH1/8"-17        | 1-5/8     |             | ICH1/8"-45        | 3-3/8     |             |
| ICH1/8"-18        | 1-11/16   |             | ICH1/8"-46        | 3-7/16    |             |
| ICH1/8"-19        | 1-3/4     |             | ICH1/8"-47        | 3-1/2     |             |
| ICH1/8"-20        | 1-13/16   |             | ICH1/8"-48        | 3-9/16    |             |
| ICH1/8"-21        | 1-7/8     |             | ICH1/8"-49        | 3-5/8     |             |
| ICH1/8"-22        | 1-15/16   |             | ICH1/8"-50        | 3-11/16   |             |
| ICH1/8"-23        | 2         |             | ICH1/8"-51        | 3-3/4     |             |
| ICH1/8"-24        | 2-1/16    |             | ICH1/8"-52        | 3-13/16   |             |
| ICH1/8"-25        | 2-1/8     |             | ICH1/8"-53        | 3-7/8     |             |
| ICH1/8"-26        | 2-3/16    |             | ICH1/8"-54        | 3-15/16   |             |
| ICH1/8"-27        | 2-1/4     |             | ICH1/8"-55        | 4         |             |
| ICH1/8"-28        | 2-5/16    |             |                   |           |             |

外径/Dia.1-1/4" ~



Dia.1-1/4"~2-3/8" φ3/8"  
Dia.2-7/16"~ φ1/2"

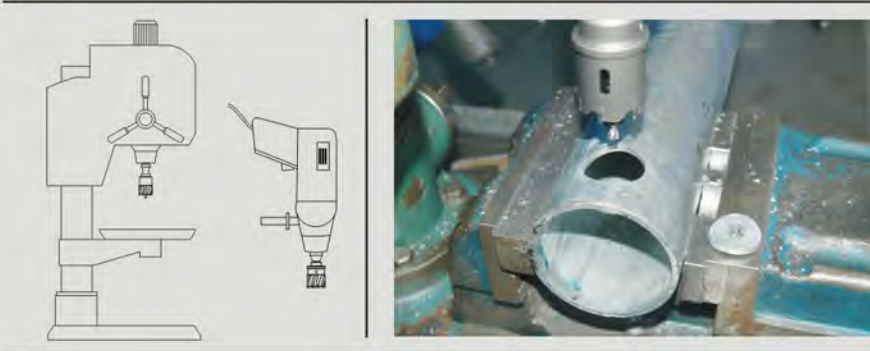

# ICHP1/8"

外径/Dia.5/8" ~1-3/16"



英制标准系列 Inch Regular Size:

<inch>

| 订货编号<br>Order NO. | 外径<br>Dia | 价格<br>Price | 订货编号<br>Order NO. | 外径<br>Dia | 价格<br>Price |
|-------------------|-----------|-------------|-------------------|-----------|-------------|
| ICHP1/8"-01       | 5/8       |             | ICHP1/8"-29       | 2-3/8     |             |
| ICHP1/8"-02       | 11/16     |             | ICHP1/8"-30       | 2-7/16    |             |
| ICHP1/8"-03       | 3/4       |             | ICHP1/8"-31       | 2-1/2     |             |
| ICHP1/8"-04       | 13/16     |             | ICHP1/8"-32       | 2-9/16    |             |
| ICHP1/8"-05       | 7/8       |             | ICHP1/8"-33       | 2-5/8     |             |
| ICHP1/8"-06       | 15/16     |             | ICHP1/8"-34       | 2-11/16   |             |
| ICHP1/8"-07       | 1         |             | ICHP1/8"-35       | 2-3/4     |             |
| ICHP1/8"-08       | 1-1/16    |             | ICHP1/8"-36       | 2-13/16   |             |
| ICHP1/8"-09       | 1-1/8     |             | ICHP1/8"-37       | 2-7/8     |             |
| ICHP1/8"-10       | 1-3/16    |             | ICHP1/8"-38       | 2-15/16   |             |
| ICHP1/8"-11       | 1-1/4     |             | ICHP1/8"-39       | 3         |             |
| ICHP1/8"-12       | 1-5/16    |             | ICHP1/8"-40       | 3-1/16    |             |
| ICHP1/8"-13       | 1-3/8     |             | ICHP1/8"-41       | 3-1/8     |             |
| ICHP1/8"-14       | 1-7/16    |             | ICHP1/8"-42       | 3-3/16    |             |
| ICHP1/8"-15       | 1-1/2     |             | ICHP1/8"-43       | 3-1/4     |             |
| ICHP1/8"-16       | 1-9/16    |             | ICHP1/8"-44       | 3-5/16    |             |
| ICHP1/8"-17       | 1-5/8     |             | ICHP1/8"-45       | 3-3/8     |             |
| ICHP1/8"-18       | 1-11/16   |             | ICHP1/8"-46       | 3-7/16    |             |
| ICHP1/8"-19       | 1-3/4     |             | ICHP1/8"-47       | 3-1/2     |             |
| ICHP1/8"-20       | 1-13/16   |             | ICHP1/8"-48       | 3-9/16    |             |
| ICHP1/8"-21       | 1-7/8     |             | ICHP1/8"-49       | 3-5/8     |             |
| ICHP1/8"-22       | 1-15/16   |             | ICHP1/8"-50       | 3-11/16   |             |
| ICHP1/8"-23       | 2         |             | ICHP1/8"-51       | 3-3/4     |             |
| ICHP1/8"-24       | 2-1/16    |             | ICHP1/8"-52       | 3-13/16   |             |
| ICHP1/8"-25       | 2-1/8     |             | ICHP1/8"-53       | 3-7/8     |             |
| ICHP1/8"-26       | 2-3/16    |             | ICHP1/8"-54       | 3-15/16   |             |
| ICHP1/8"-27       | 2-1/4     |             | ICHP1/8"-55       | 4         |             |
| ICHP1/8"-28       | 2-5/16    |             |                   |           |             |

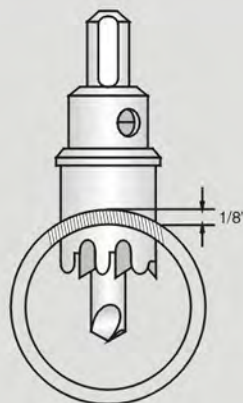

外径/Dia.1-1/4" ~



Dia.1-1/4"-2-3/8" φ 3/8"  
Dia.2-7/16"- φ 1/2"

# APP



## 顶针 Pilot Pins:

| 订货编号<br>Order NO. | 规格<br>Spec. | 价格<br>Price |
|-------------------|-------------|-------------|
| APP90-6           | Φ6.35X90    |             |
| APP90-8           | Φ8X90       |             |
| APP105-6          | Φ6.35X105   |             |
| APP105-8          | Φ8X105      |             |

# ATHW



## 削平柄钢板钻专用夹头 Tool Holders for Core Drills with Weldon Shank:

| 订货编号<br>Order NO. | 孔径<br>Dia.    | 莫氏锥号<br>MT | 价格<br>Price |
|-------------------|---------------|------------|-------------|
| ATHW19-2#         | 19.05(3/4")   | 2#         |             |
| ATHW19-3#         | 19.05(3/4")   | 3#         |             |
| ATHW19-4#         | 19.05(3/4")   | 4#         |             |
| ATHW32-3#         | 31.75(1-1/4") | 3#         |             |
| ATHW32-4#         | 31.75(1-1/4") | 4#         |             |
| ATHW32-5#         | 31.75(1-1/4") | 5#         |             |

# ATHT



## 螺纹柄钢板钻专用夹头 Tool Holders for Core Drills with Thread Shank:

| 订货编号<br>Order NO. | 孔径<br>Dia.   | 莫氏锥号<br>MT | 价格<br>Price |
|-------------------|--------------|------------|-------------|
| ATHT-2#           | M18X6(P=1.5) | 2#         |             |
| ATHT-3#           | M18X6(P=1.5) | 3#         |             |
| ATHT-4#           | M18X6(P=1.5) | 4#         |             |



- 1.开始钻孔前必须确保刀具已完全安装到位,没有松动或未夹紧的现象。
- 2.使用磁座钻机钻孔时必须保证钻机磁块下无铁屑,吸附面平整,机器无摇摆或未完全吸附的现象。
- 3.开始钻孔直至钻孔完成的全过程应保持冷却充分,有条件的最好采用内冷却,不充分冷却易引起刀具损坏。
- 4.钻孔刚开始时应进刀缓慢平稳,切入1~2mm后可以加快进刀速度。出刀时适当减慢走刀速度,中间切削过程应保持进刀均匀。
- 5.硬质合金钢板钻钻孔时合理的刀刃线速度应在每分钟30米左右,最低不应低于每分钟20米。可按下表选取相应的转速(rpm):  
特殊规格的钻头不在此表中显示。

### 转速推荐表/ RPM Recommendation

| 钻孔直径<br>Dia.<br>线速度 V <sub>c</sub> | φ14 | φ16 | φ18 | φ20 | φ22 | φ24 | φ26 | φ28 | φ30 | φ32 |
|------------------------------------|-----|-----|-----|-----|-----|-----|-----|-----|-----|-----|
| 20m/min                            | 455 | 398 | 354 | 318 | 289 | 265 | 245 | 227 | 212 | 199 |
| 30m/min                            | 682 | 596 | 530 | 478 | 434 | 398 | 367 | 341 | 318 | 298 |

| 钻孔直径<br>Dia.<br>线速度 V <sub>c</sub> | φ34 | φ36 | φ38 | φ40 | φ42 | φ44 | φ46 | φ48 | φ50 | φ52 |
|------------------------------------|-----|-----|-----|-----|-----|-----|-----|-----|-----|-----|
| 20m/min                            | 187 | 177 | 168 | 159 | 152 | 145 | 138 | 133 | 127 | 122 |
| 30m/min                            | 281 | 265 | 251 | 238 | 227 | 217 | 208 | 199 | 191 | 184 |

| 钻孔直径<br>Dia.<br>线速度 V <sub>c</sub> | φ54 | φ56 | φ58 | φ60 | φ62 | φ64 | φ66 | φ68 | φ70 | φ75 |
|------------------------------------|-----|-----|-----|-----|-----|-----|-----|-----|-----|-----|
| 20m/min                            | 118 | 114 | 110 | 106 | 103 | 99  | 96  | 94  | 91  | 85  |
| 30m/min                            | 177 | 171 | 165 | 159 | 154 | 149 | 145 | 140 | 136 | 127 |

- 6.硬质合金是高硬度的材料,存放和领用过程中应防止刀片磕碰,使用过程中应防止冲击。
- 7.入刀时若产生剧烈振动,需检查转速是否太高,还需检查机器导轨是否间隙太大,必要时进行维修或调整。
- 8.钻孔过程中如遇闷车停机现象,应首先切断电源,手工反向稍微转动刀具,使刀刃脱离切削区域,再提起电机取下刀具,经查看无异常后可重新开始作业。
- 9.缠绕在刀体上的铁屑过多时,可以退刀后,用钩子去除。
- 10.中心顶针用于顶料芯,使用时不能有明显的跳动,如发现顶针弯曲应及时更换。
- 11.钻孔后芯料未弹出时,可轻微敲击芯料底部或刀体侧面辅助芯料弹出。还不能弹出芯料,可取下刀具,利用柄部小孔轻轻撞击芯料使芯料取出。取芯料过程应注意安全,切勿碰伤刀刃。
- 12.钻深孔时如遇阻力大,可多次退刀,以协助刀具排屑。退刀后再次钻孔时,如发生钻不下去的情况,需先清理孔中铁屑,再继续钻孔。
- 13.整个钻孔过程要确保安全,注意防护。



**炬锋工具股份有限公司**  
**EST TOOLS CO., LTD.**  
**嘉兴亿爱思梯进出口有限公司**  
**JIAXING EST IMPORT & EXPORT CO., LTD.**

地址: 浙江·海盐新桥北路239号  
 Address: No.239 Xinqiao North Road, Haiyan,  
 Zhejiang, China  
 Phone: +86-573-86169516 86169512  
 Fax: +86-573-86122456  
 Postcode: 314300  
<http://www.esttools.com>  
 E-mail: sales@esttools.com