

# Profile and Form Milling Cutters ▶





## End Mills ▶

We manufacture many kinds of metric or inch standard milling cutters, according to DIN, JIS and ANSI standard.

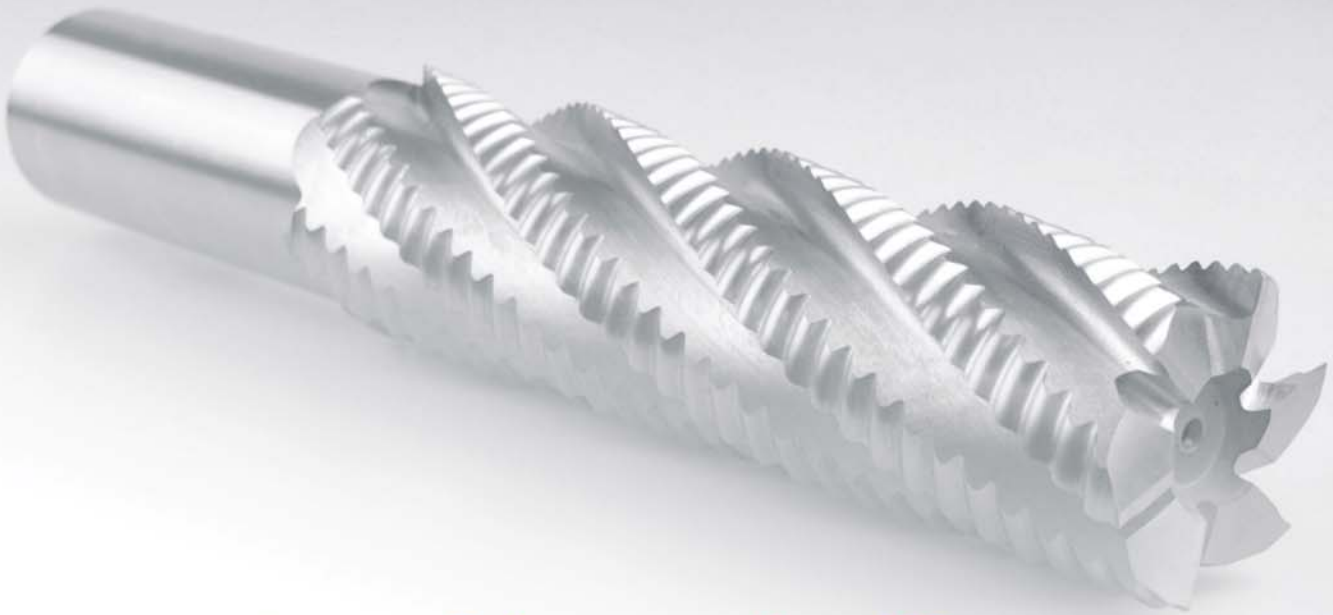

## Roughing end mills▶

| Inch Sizes     |       |       |       |        |   |  |
|----------------|-------|-------|-------|--------|---|--|
| No.            | d     | d1    | L2    | L1     | Z |  |
| I-NR-BC<K>401R | 1/4   | 3/8   | 5/8   | 2-7/16 | 4 |  |
| I-NR-BC<K>402R | 5/16  | 3/8   | 3/4   | 2-1/2  | 4 |  |
| I-NR-BC<K>403R | 3/8   | 3/8   | 3/4   | 2-7/16 | 4 |  |
| I-NR-BC<K>404R | 1/2   | 1/2   | 1-1/4 | 3-1/4  | 4 |  |
| I-NR-BC<K>405R | 5/8   | 5/8   | 1-5/8 | 3-3/4  | 4 |  |
| I-NR-BC<K>406R | 3/4   | 5/8   | 1-5/8 | 3-3/4  | 4 |  |
| I-NR-BC<K>407R | 3/4   | 3/4   | 1-5/8 | 3-7/8  | 4 |  |
| I-NR-BC<K>408R | 7/8   | 3/4   | 1-7/8 | 4-1/8  | 4 |  |
| I-NR-BC<K>409R | 7/8   | 7/8   | 1-7/8 | 4-1/8  | 4 |  |
| I-NR-BC<K>410R | 1     | 3/4   | 2     | 4-1/4  | 4 |  |
| I-NR-BC<K>411R | 1     | 1     | 2     | 4-1/2  | 4 |  |
| I-NR-BC<K>512R | 1-1/8 | 1     | 2     | 4-1/2  | 5 |  |
| I-NR-BC<K>513R | 1-1/4 | 1     | 2     | 4-1/2  | 5 |  |
| I-NR-BC<K>514R | 1-1/4 | 1-1/4 | 2     | 4-1/2  | 5 |  |
| I-NR-BC<K>615R | 1-1/2 | 1-1/4 | 2     | 4-1/2  | 6 |  |
| I-NR-BC<K>616R | 1-3/4 | 1-1/4 | 2     | 4-1/2  | 6 |  |
| I-NR-BC<K>617R | 2     | 1-1/4 | 2     | 4-1/2  | 6 |  |
| I-NR-BC<K>618R | 2     | 2     | 2     | 5-3/4  | 6 |  |
| I-NR-BC<K>819R | 2     | 1-1/4 | 2     | 4-1/2  | 8 |  |

Details please refer to brochure "Milling cutters"



## Non-standard drillings and milling cutters ▶

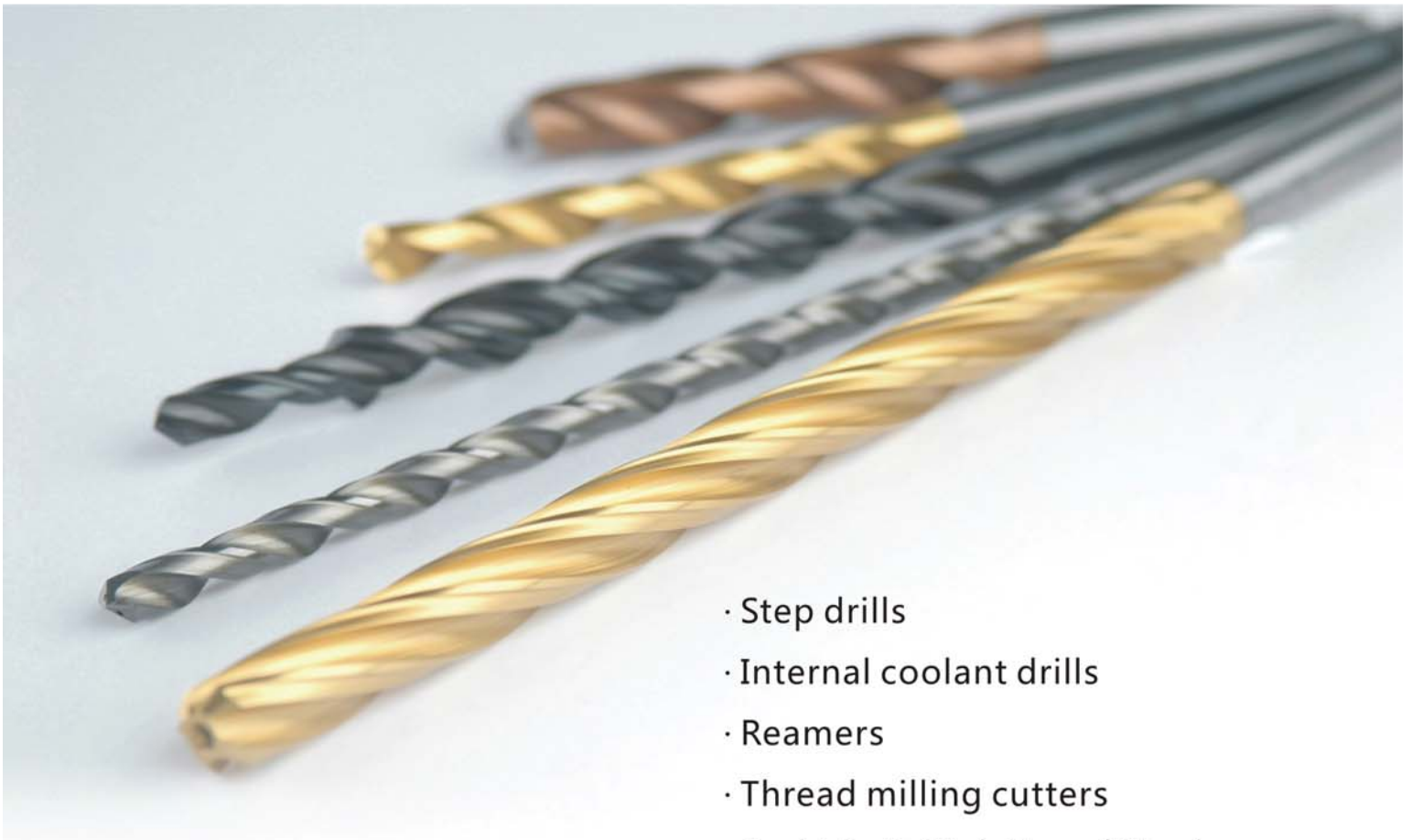

- Step drills
- Internal coolant drills
- Reamers
- Thread milling cutters
- Carbide & High Speed Steel







# Hole Saws & Hole Cutters ▶

High Speed Steel and Carbide Tip

**Cutting Depth :**  
**0.5-150 mm ( 1/8—5-7/8 inch )**

**Diameter :**  
**12-200 mm ( 1/2—7-13/16 inch )**

- Fein Quick-In Shank
- Thread Shank
- Universal Shank
- Weldon Shank
- Hex Shank





## Ordering Key

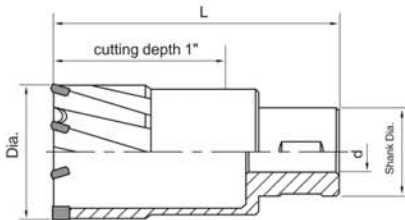
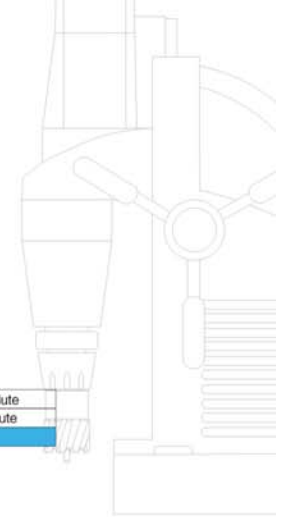
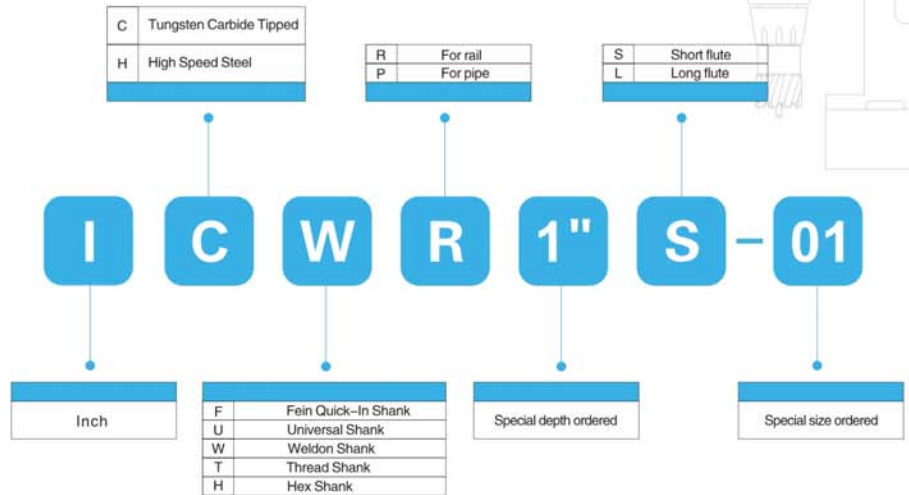

Shank Dia:  
Dia. 1/2"–2-1/2"    Shank Dia. 3/4"  
Dia. 2-9/16" ~    Shank Dia. 1-1/4"

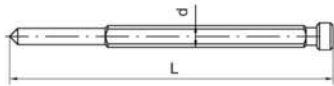

Suitable for diameter from 1/2" to 11/16"

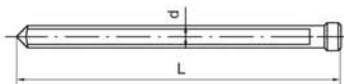

Suitable for diameter from 3/4" to 4"

| Inch Sizes |       |          |       |
|------------|-------|----------|-------|
| No.        | Dia   | No.      | Dia   |
| ICW1"-01   | 1/2   | ICW1"-31 | 2-3/8 |
| ICW1"-03   | 5/8   | ICW1"-33 | 2-1/2 |
| ICW1"-05   | 3/4   | ICW1"-35 | 2-5/8 |
| ICW1"-07   | 7/8   | ICW1"-37 | 2-3/4 |
| ICW1"-09   | 1     | ICW1"-39 | 2-7/8 |
| ICW1"-11   | 1-1/8 | ICW1"-41 | 3     |
| ICW1"-13   | 1-1/4 | ICW1"-43 | 3-1/8 |
| ICW1"-15   | 1-3/8 | ICW1"-45 | 3-1/4 |
| ICW1"-17   | 1-1/2 | ICW1"-47 | 3-3/8 |
| ICW1"-19   | 1-5/8 | ICW1"-49 | 3-1/2 |
| ICW1"-21   | 1-3/4 | ICW1"-51 | 3-5/8 |
| ICW1"-23   | 1-7/8 | ICW1"-53 | 3-3/4 |
| ICW1"-25   | 2     | ICW1"-55 | 3-7/8 |
| ICW1"-27   | 2-1/8 | ICW1"-57 | 4     |
| ICW1"-29   | 2-1/4 |          |       |

Details please refer to brochure "Hole Saws"